

# **INITIAL RECEIPT**

**United States Department of the Interior**  
**Bureau of Land Management**  
 DIV OF LANDS, MINRLS & ENERGY  
 ONE N CENTRAL AVE  
 PHOENIX, AZ 85004 -4427  
 Phone: 602-417-9200

Receipt

No:

4802348

**Transaction #:** 4929685

**Date of Transaction:** 09/11/2020

**CUSTOMER:**

RON PARKER  
 14700 N SHOTGUN PL  
 ORO VALLEY,AZ 85755-8811 US

LINE #	QTY	DESCRIPTION	REMARKS	UNIT PRICE	TOTAL
1	32.00	LOCATABLE MINERALS / MINING CLAIMS- NEW,UNADJUD, ONE OR MORE AUTH NOS / NEW MINING CLAIM PROCESSING FEE <b>CASES:</b> AMC460983/\$20.00, AMC460984/\$20.00, AMC460985/\$20.00, AMC460986/\$20.00, AMC460987/\$20.00, AMC460988/\$20.00, AMC460989/\$20.00, AMC460990/\$20.00, AMC460991/\$20.00, AMC460992/\$20.00, AMC460993/\$20.00, AMC460994/\$20.00, AMC460995/\$20.00, AMC460996/\$20.00, AMC460997/\$20.00, AMC460998/\$20.00, AMC460999/\$20.00, AMC461000/\$20.00, AMC461001/\$20.00, AMC461002/\$20.00, AMC461003/\$20.00, AMC461004/\$20.00, AMC461005/\$20.00, AMC461006/\$20.00, AMC461007/\$20.00, AMC461008/\$20.00, AMC461009/\$20.00, AMC461010/\$20.00, AMC461011/\$20.00, AMC461012/\$20.00, AMC461013/\$20.00, AMC461014/\$20.00		- n/a -	640.00
2	32.00	LOCATABLE MINERALS / MINING CLAIMS- NEW,UNADJUD, ONE OR MORE AUTH NOS / NEW MINING CLAIMS LOCATION FEE <b>CASES:</b> AMC460983/\$40.00, AMC460984/\$40.00, AMC460985/\$40.00, AMC460986/\$40.00, AMC460987/\$40.00, AMC460988/\$40.00, AMC460989/\$40.00, AMC460990/\$40.00, AMC460991/\$40.00, AMC460992/\$40.00, AMC460993/\$40.00, AMC460994/\$40.00, AMC460995/\$40.00, AMC460996/\$40.00, AMC460997/\$40.00, AMC460998/\$40.00, AMC460999/\$40.00, AMC461000/\$40.00, AMC461001/\$40.00, AMC461002/\$40.00, AMC461003/\$40.00, AMC461004/\$40.00, AMC461005/\$40.00, AMC461006/\$40.00, AMC461007/\$40.00, AMC461008/\$40.00, AMC461009/\$40.00, AMC461010/\$40.00, AMC461011/\$40.00, AMC461012/\$40.00, AMC461013/\$40.00, AMC461014/\$40.00		- n/a -	1280.00
3	32.00	LOCATABLE MINERALS / MINING CLAIMS- NEW,UNADJUD, ONE OR MORE AUTH NOS / NEW MINING CLAIMS MAINTENANCE FEE <b>CASES:</b> AMC460983/\$165.00, AMC460984/\$165.00, AMC460985/\$165.00, AMC460986/\$165.00,		n/a	5280.00

**SCANNED**  
**ENTERED**  
**SEP 16 2020**  
 BY: *WV*



AMC460987/\$165.00, AMC460988/\$165.00,  
AMC460989/\$165.00, AMC460990/\$165.00,  
AMC460991/\$165.00, AMC460992/\$165.00,  
AMC460993/\$165.00, AMC460994/\$165.00,  
AMC460995/\$165.00, AMC460996/\$165.00,  
AMC460997/\$165.00, AMC460998/\$165.00,  
AMC460999/\$165.00, AMC461000/\$165.00,  
AMC461001/\$165.00, AMC461002/\$165.00,  
AMC461003/\$165.00, AMC461004/\$165.00,  
AMC461005/\$165.00, AMC461006/\$165.00,  
AMC461007/\$165.00, AMC461008/\$165.00,  
AMC461009/\$165.00, AMC461010/\$165.00,  
AMC461011/\$165.00, AMC461012/\$165.00,  
AMC461013/\$165.00, AMC461014/\$165.00

**TOTAL:** **\$7,200.00**

**PAYMENT INFORMATION**

1	AMOUNT:	7200.00	POSTMARKED:	N/A
	TYPE:	CHECK	RECEIVED:	09/11/2020
	CHECK NO:	1156		
	NAME:	PARKER, RON 14700 N SHOTGUN PL ORO VALLEY AZ 85755-8811 US		

**REMARKS**

This receipt was generated by the automated BLM Collections and Billing System and is a paper representation of a portion of the official electronic record contained therein.

0503 01 942

# **CORRESPONDENCE**

# **TRANSFERS**



**MAINTENANCE FEES**  
**WAIVERS**  
**POL/NOI**

# **MISCELLANEOUS**

R & D Adventures LLC  
14700 Shotgun Pl.  
Oro Valley, AZ. 85737  
(520) 825-5359  
rocktosser@comcast.net

**September 9, 2020**

**BLM**

**Please return the enclosed claim notices AA8-01 through AA8-32  
to:**

**R & D Adventures LLC  
14700 N Shotgun Place  
Oro Valley, AZ 85755**

**Please find enclosed a check for \$7,200.**

**Thank you,**

*Ron Parker*

AMC460983

RECEIVED  
BLM AZ STATE OFFICE  
2020 SEP 11 A 8:18  
PHOENIX, ARIZONA



**LOCATION NOTICES  
AMENDMENTS  
STATUS SHEET  
GEO REPORT/MTP**

Data Entered: 9/16/2020 WC

*no* MTP Checked By: DE  
*no* GEO Checked By: \_\_\_\_\_

LEAD SERIAL NUMBER: AMC 460 983 thru AMC 461014

**CHARGES:**

Processing Fee @ \$20 =	\$	640-
Location Fee @ \$40 =	\$	1280-
Maintenance Fee @ \$165 =	\$	5280
Print Fee for Assoc Placer =	\$	
<b>SUBTOTAL</b>	\$	

**TOTAL ACREAGE:** \_\_\_\_\_ *Per Claim*  
(Placer Only)

Other Fees \$  
Other Fees \$  
**TOTAL** \$ 7200<sup>00</sup>

NUMBER OF LOCATORS: 1

DOCUMENTS RECEIVED VIA : Over-the-Counter [ ] Mail ☒ TIMELY FILED: Yes ☒ No [ ]

**LEGAL DESCRIPTION:**

T	95	R	11E	SEC	B
T		R		SEC	
T		R		SEC	
T		R		SEC	
T		R		SEC	

BLM [ ] FOREST SERVICE [ ] \_\_\_\_\_ SUBJ TO PL 359: Yes [ ] No [ ]  
WILDERNESS AREA [ ]

**SPLIT ESTATE:** N/A ☐ SX ☐ PX ☐ OTHER ☐ \_\_\_\_\_  
SRHA ☐ Was proper Notice filed if located on SHRA Land? Yes ☐ No ☐

**RECONVEYED MINERALS ON BLM LAND REQUIRE OPENING ORDER FROM 1944 TO 1993:**

Open to Entry On N/A [ ]

COMMENTS/STATUS: VOID [ ] PARTIALLY VOID [ ] PVT MINERALS [ ] WITHDRAWN LANDS [ ]  
OTHER [ ]

*[ ] Claimant acknowledges that portions of the following claim(s) site(s) may be void or voidable.*

Printed Name of Claimant \_\_\_\_\_ Signature of Claimant \_\_\_\_\_

\*\*\*\*\*FINAL ADJUDICATION\*\*\*\*\*

DATE	INITIALS
------	----------

# **LOCATION NOTICE FOR PLACER MINING CLAIM**

NOTICE IS HEREBY GIVEN that the AA8-01 placer mining claim has been located by Arizona Assets, LLC whose current mailing address is 292 new river Cir., Henderson, Nevada 89052-2377

BLM	RECEIVED
DATE	BLM AZ STATE OFFICE
STAMP	2020 SEP 11 A 8:18
	PHOENIX, ARIZONA

The general course of this claim is East to West and is situated in Pinal County, Arizona.

The claim is 1,320 feet in length and 660 feet in width. This claim runs from the location monument on which the location notice is posted (being the northeast corner of the said claim), approximately 660 feet in a southerly direction to the south end line and 1,320 feet in a westerly direction to the west end line.

The claim is marked by four 2"x2"x4' monuments, one at each corner of the claim.

The location monument on which this notice is posted is situated within Section 8, Township 9 South, Range 11 East, Gila Salt River Base and Meridian, Arizona. This claim encompasses portions of the following quarter section (s), section (s), Township (s) and Range (s)

N 1/2 of the NE 1/4 of the NE 1/4 of Section 8, Township 9, Range 11 South, Gila Salt River Base and Meridian, Arizona.

The locality of this claim with reference to some natural object or permanent monument and additional information (if any) concerning its locality are as follows: none

DATED AND POSTED on the ground this 4th day of September, 2020.

LOCATOR (s) Owner  
Arizona Assets, LLC

By Ron Parker

Ron Parker/Agent for Owners

AMC460983



# T9S R11E SECTION 8

## ARIZONA ASSETS AA CLAIM BLOCK

### AA8 CLAIM 01 THROUGH 32

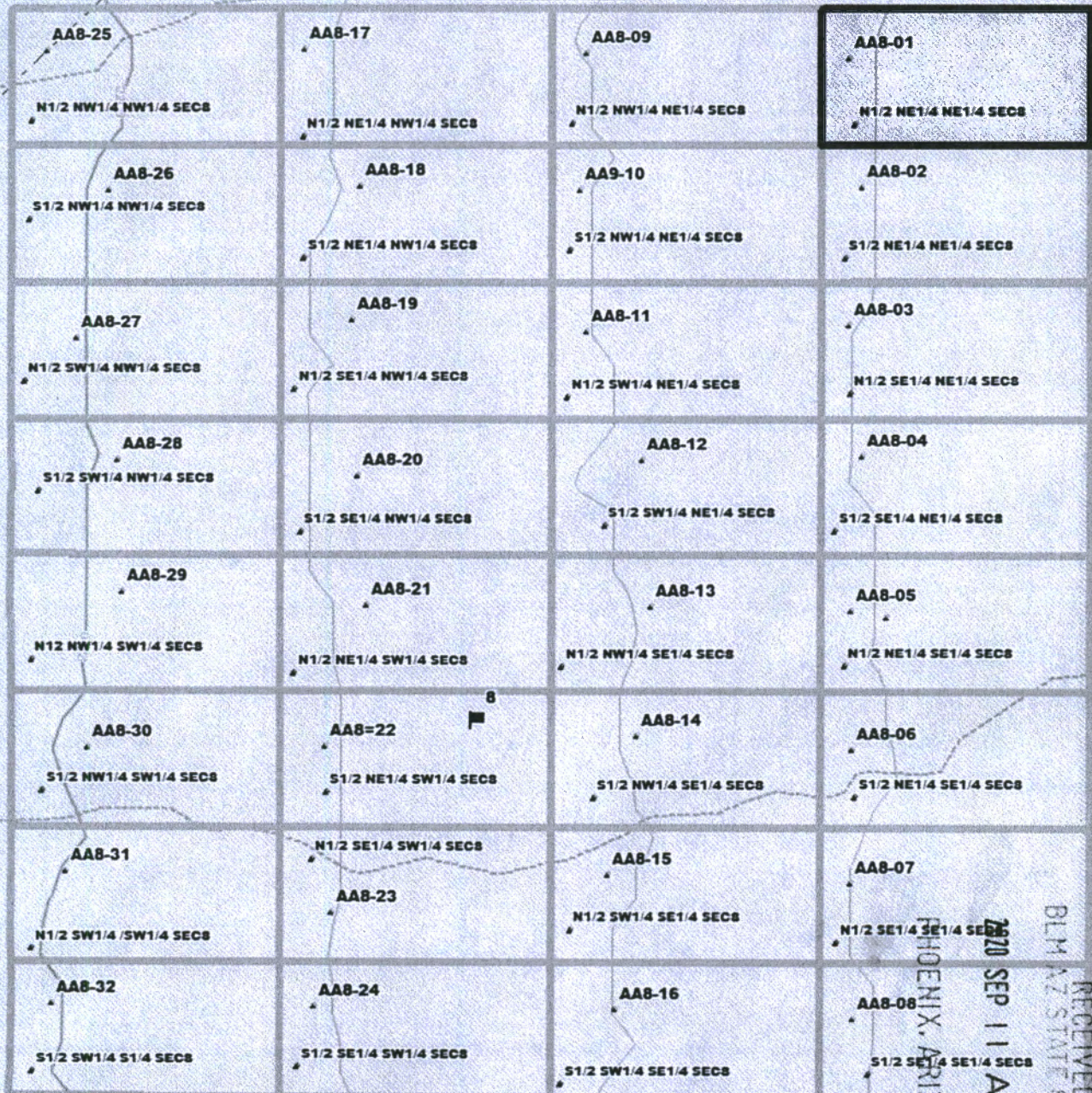

AMC460983

RECEIVED  
BLM AZ STATE OFFICE  
2020 SEP 11 A 8:18  
PHOENIX, ARIZONA

Data use subject to license.

© DeLorme. Topo North America™ 10.

www.delorme.com



MN (9.7° E)



Data Zoom 14-3



**LOCATION NOTICE FOR PLACER MINING CLAIM**

NOTICE IS HEREBY GIVEN that the AA8-02 placer mining claim has been located by Arizona Assets, LLC whose current mailing address is 292 new river Cir., Henderson, Nevada 89052-2377

BLM	RECEIVED
DATE	BLM AZ STATE OFFICE
STAMP	2020 SEP 11 A 8:18
	PHOENIX, ARIZONA

The general course of this claim is East to West and is situated in Pinal County, Arizona.

The claim is 1,320 feet in length and 660 feet in width. This claim runs from the location monument on which the location notice is posted (being the northeast corner of the said claim), approximately 660 feet in a southerly direction to the south end line and 1,320 feet in a westerly direction to the west end line.

The claim is marked by four 2"x2"x4' monuments, one at each corner of the claim.

The location monument on which this notice is posted is situated within Section 8, Township 9 South, Range 11 East, Gila Salt River Base and Meridian, Arizona. This claim encompasses portions of the following quarter section (s), section (s), Township (s) and Range (s)

S 1/2 of the NE 1/4 of the NE 1/4 of Section 8, Township 9, Range 11 South, Gila Salt River Base and Meridian, Arizona.

The locality of this claim with reference to some natural object or permanent monument and additional information (if any) concerning its locality are as follows: none

DATED AND POSTED on the ground this 4th day of September, 2020.

LOCATOR (s) Owner  
Arizona Assets, LLC

By Ron Parker

Ron Parker/Agent for Owners

AMC460984



# T9S R11E SECTION 8

## ARIZONA ASSETS AA CLAIM BLOCK

### AA8 CLAIM 01 THROUGH 32

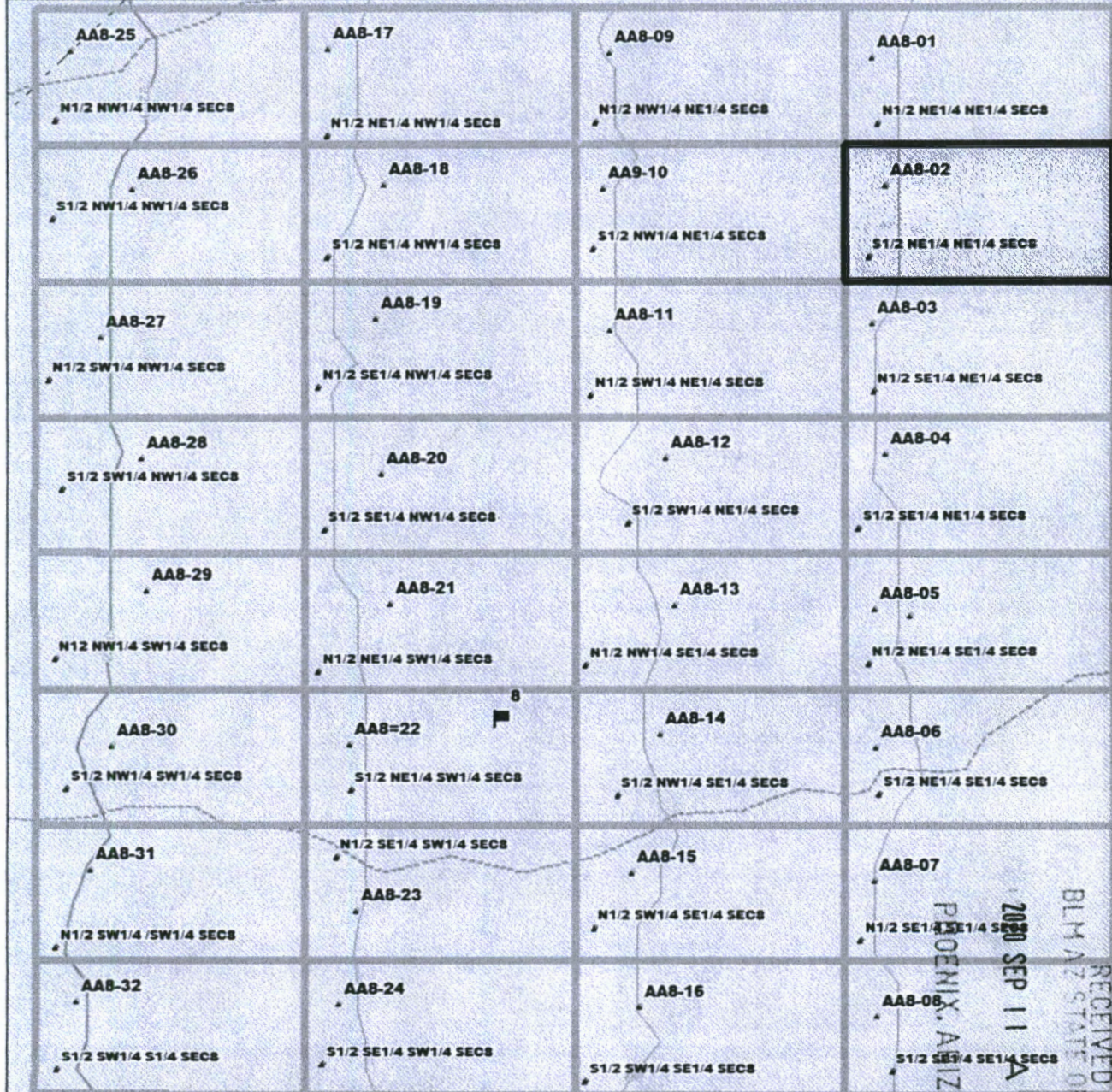

AMC460984

RECEIVED  
BLM AZ STATE OFFICE  
2020 SEP 11 A 8:18  
PHOENIX, ARIZONA

Data use subject to license

© DeLorme. Topo North America™ 10.

www.delorme.com

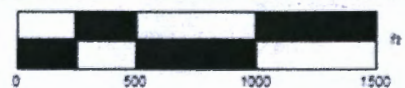

Data Zoom 14-3



# **LOCATION NOTICE FOR PLACER MINING CLAIM**

NOTICE IS HEREBY GIVEN that the AA8-03 placer mining claim has been located by Arizona Assets, LLC whose current mailing address is 292 new river Cir., Henderson, Nevada 89052-2377

BLM	2020 SEP 11 A 8:18	RECEIVED
DATE	PHOENIX, ARIZONA	BLM AZ STATE OFFICE
STAMP		

The general course of this claim is East to West and is situated in Pinal County, Arizona.

The claim is 1,320 feet in length and 660 feet in width. This claim runs from the location monument on which the location notice is posted (being the northeast corner of the said claim), approximately 660 feet in a southerly direction to the south end line and 1,320 feet in a westerly direction to the west end line.

The claim is marked by four 2"x2"x4' monuments, one at each corner of the claim.

The location monument on which this notice is posted is situated within Section 8, Township 9 South, Range 11 East, Gila Salt River Base and Meridian, Arizona. This claim encompasses portions of the following quarter section (s), section (s), Township (s) and Range (s)

N 1/2 of the SE 1/4 of the NE 1/4 of Section 8, Township 9, Range 11 South, Gila Salt River Base and Meridian, Arizona.

The locality of this claim with reference to some natural object or permanent monument and additional information (if any) concerning its locality are as follows: none

DATED AND POSTED on the ground this 4th day of September, 2020.

LOCATOR (s) Owner  
Arizona Assets, LLC

By Ron Parker

Ron Parker/Agent for Owners

AMC460985



# T9S R11E SECTION 8

## ARIZONA ASSETS AA CLAIM BLOCK

### AA8 CLAIM 01 THROUGH 32

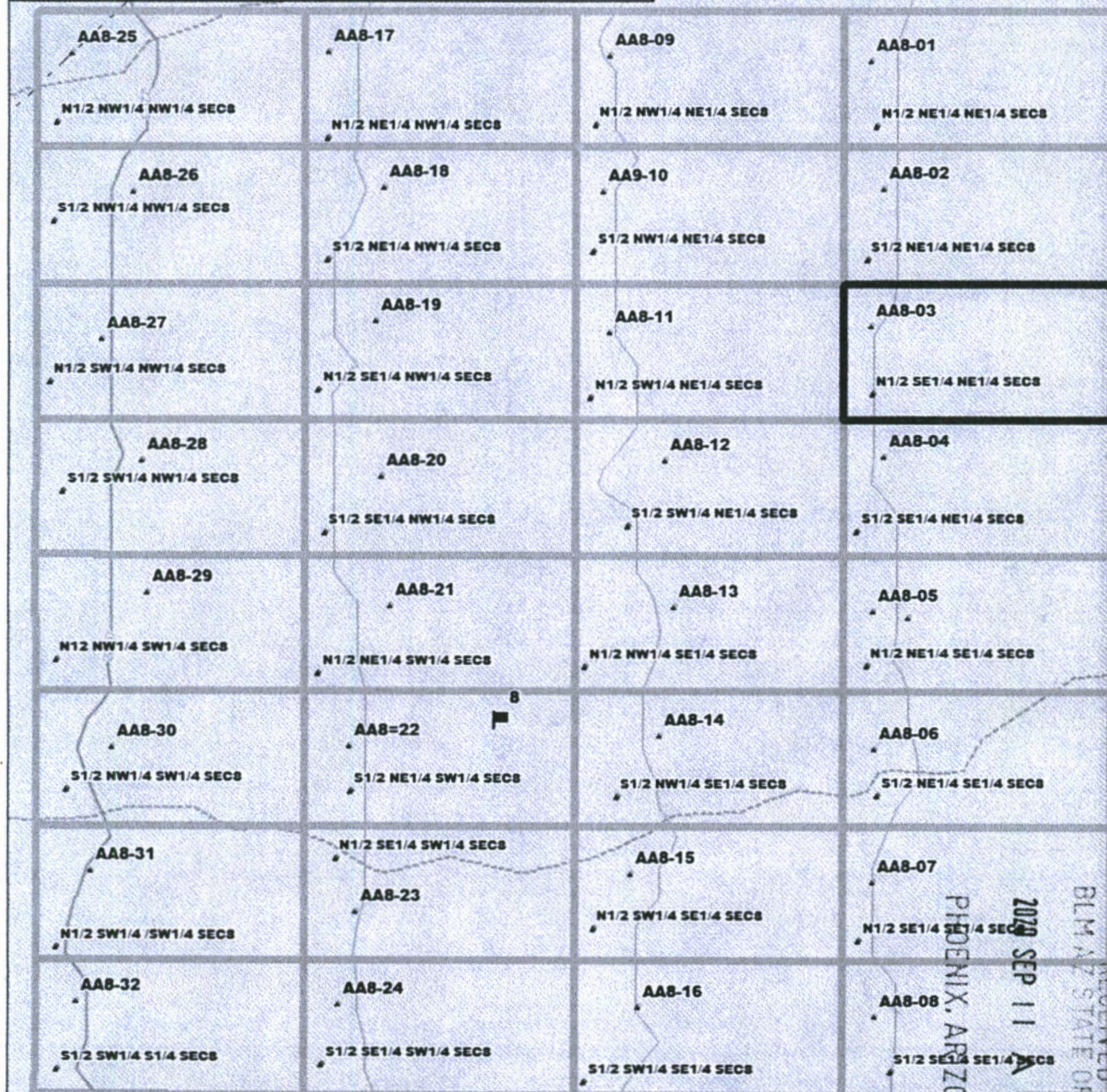

AMC460985

RECEIVED  
BLM AZ STATE OFFICE  
2020 SEP 11 A 8:18  
PHOENIX, ARIZONA

Data use subject to license.

© DeLorme. Topo North America™ 10.

www.delorme.com



MN (9.7° E)

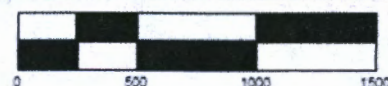

Data Zoom 14-3



**LOCATION NOTICE FOR PLACER MINING CLAIM**

NOTICE IS HEREBY GIVEN that the AA8-04 placer mining claim has been located by Arizona Assets, LLC whose current mailing address is 292 new river Cir., Henderson, Nevada 89052-2377

BLM	RECEIVED
DATE	BLM AZ STATE OFFICE
STAMP	2020 SEP 11 A 8:18
	PHOENIX, ARIZONA

The general course of this claim is East to West and is situated in Pinal County, Arizona.

The claim is 1,320 feet in length and 660 feet in width. This claim runs from the location monument on which the location notice is posted (being the northeast corner of the said claim), approximately 660 feet in a southerly direction to the south end line and 1,320 feet in a westerly direction to the west end line.

The claim is marked by four 2"x2"x4' monuments, one at each corner of the claim.

The location monument on which this notice is posted is situated within Section 8, Township 9 South, Range 11 East, Gila Salt River Base and Meridian, Arizona. This claim encompasses portions of the following quarter section (s), section (s), Township (s) and Range (s)

S 1/2 of the NE 1/4 of the SE 1/4 of the NE 1/4 of Section 8, Township 9, Range 11 South, Gila Salt River Base and Meridian, Arizona.

The locality of this claim with reference to some natural object or permanent monument and additional information (if any) concerning its locality are as follows: none

DATED AND POSTED on the ground this 4th day of September, 2020.

LOCATOR (s) Owner  
Arizona Assets, LLC

By Ron Parker

Ron Parker/Agent for Owners

AMC460986



# T9S R11E SECTION 8

## ARIZONA ASSETS AA CLAIM BLOCK

### AA8 CLAIM 01 THROUGH 32

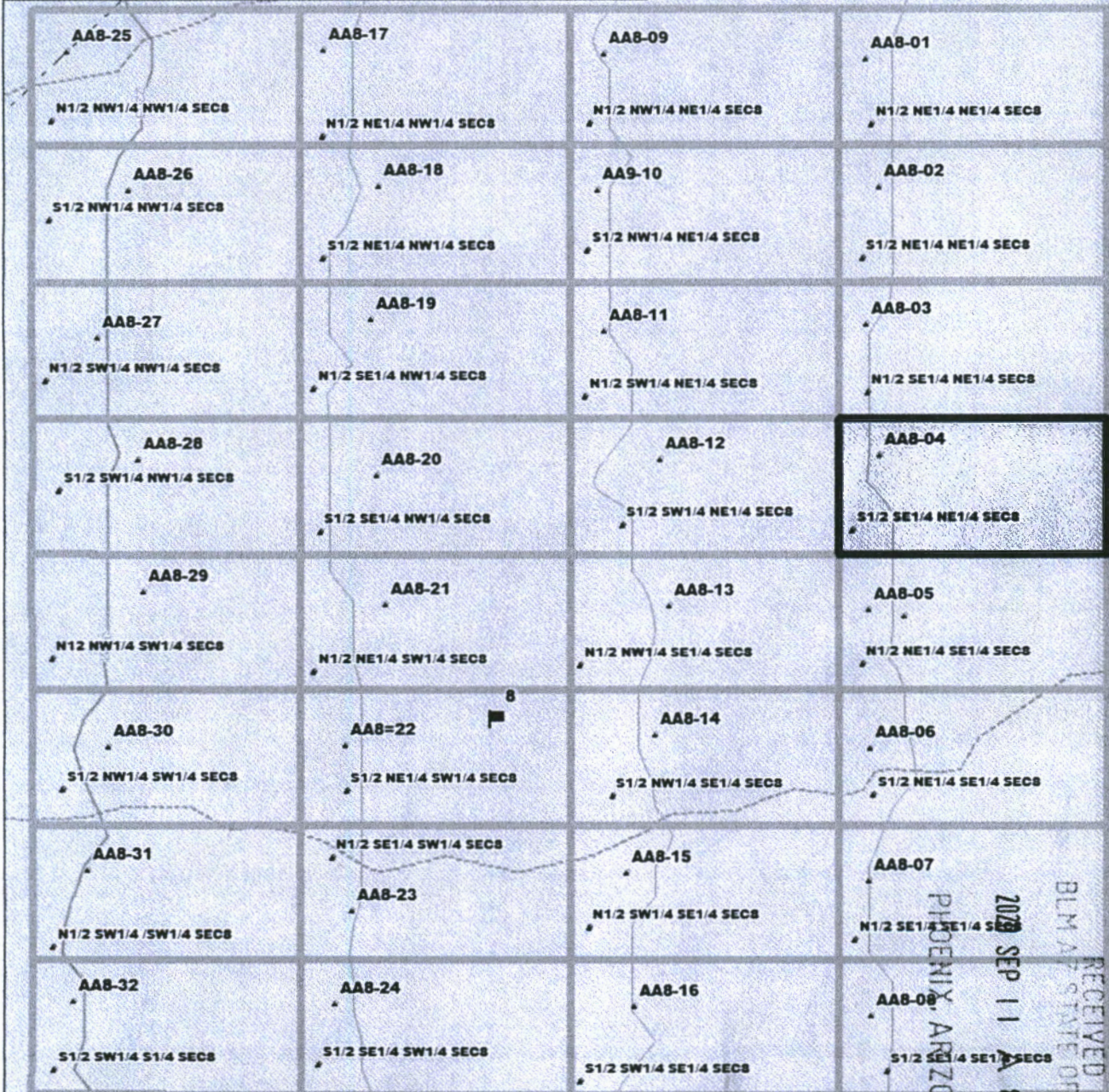

AMC460986

RECEIVED  
BLM ARIZONA STATE OFFICE  
2023 SEP 11 10:19  
PHOENIX, ARIZONA

Data use subject to license

© DeLorme. Topo North America™ 10.

www.delorme.com

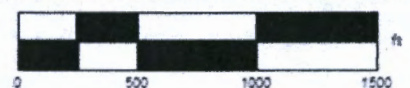

Data Zoom 14-3



**LOCATION NOTICE FOR PLACER MINING CLAIM**

NOTICE IS HEREBY GIVEN that the AA8-05 placer mining claim has been located by Arizona Assets, LLC whose current mailing address is 292 new river Cir., Henderson, Nevada 89052-2377

BLM	RECEIVED
DATE	BLM AZ STATE OFFICE
STAMP	2020 SEP 11 A 8:19
	PHOENIX, ARIZONA

The general course of this claim is East to West and is situated in Pinal County, Arizona.

The claim is 1,320 feet in length and 660 feet in width. This claim runs from the location monument on which the location notice is posted (being the northeast corner of the said claim), approximately 660 feet in a southerly direction to the south end line and 1,320 feet in a westerly direction to the west end line.

The claim is marked by four 2"x2"x4' monuments, one at each corner of the claim.

The location monument on which this notice is posted is situated within Section 8, Township 9 South, Range 11 East, Gila Salt River Base and Meridian, Arizona. This claim encompasses portions of the following quarter section (s), section (s), Township (s) and Range (s)

N 1/2 of the NE 1/4 of the SE 1/4 of Section 8, Township 9, Range 11 South, Gila Salt River Base and Meridian, Arizona.

The locality of this claim with reference to some natural object or permanent monument and additional information (if any) concerning its locality are as follows: none

DATED AND POSTED on the ground this 4th day of September, 2020.

LOCATOR (s) Owner  
Arizona Assets, LLC

By Ron Parker

Ron Parker/Agent for Owners

AMC460987



# T9S R11E SECTION 8

## ARIZONA ASSETS AA CLAIM BLOCK

### AA8 CLAIM 01 THROUGH 32

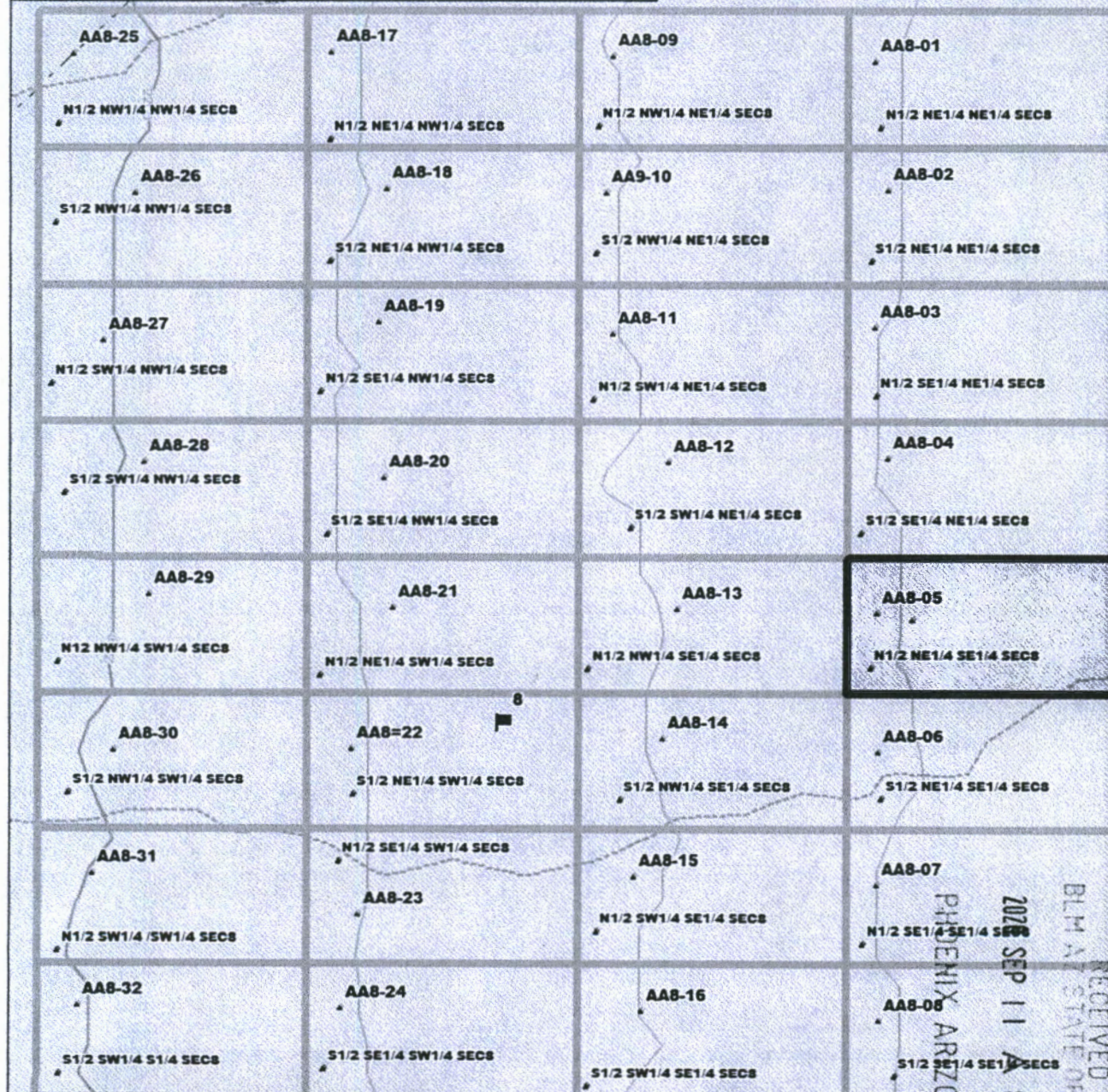

AMC460987

RECEIVED  
BLM STATE OFFICE  
2022 SEP 11 10:19  
PHOENIX, ARIZONA

Data use subject to license.

© DeLorme. Topo North America™ 10.

www.delorme.com



MN (9.7° E)

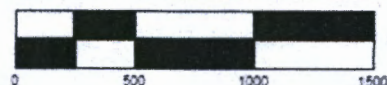

Data Zoom 14-3



**LOCATION NOTICE FOR PLACER MINING CLAIM**

NOTICE IS HEREBY GIVEN that the AA8-06 placer mining claim has been located by Arizona Assets, LLC whose current mailing address is 292 new river Cir., Henderson, Nevada 89052-2377

BLM	RECEIVED
DATE	BLM AZ STATE OFFICE
STAMP	2020 SEP 11 A 8:19
	PHOENIX, ARIZONA

The general course of this claim is East to West and is situated in Pinal County, Arizona.

The claim is 1,320 feet in length and 660 feet in width. This claim runs from the location monument on which the location notice is posted (being the northeast corner of the said claim), approximately 660 feet in a southerly direction to the south end line and 1,320 feet in a westerly direction to the west end line.

The claim is marked by four 2"x2"x4' monuments, one at each corner of the claim.

The location monument on which this notice is posted is situated within Section 8, Township 9 South, Range 11 East, Gila Salt River Base and Meridian, Arizona. This claim encompasses portions of the following quarter section (s), section (s), Township (s) and Range (s)

S 1/2 of the NE 1/4 of the SE 1/4 of Section 8, Township 9, Range 11 South, Gila Salt River Base and Meridian, Arizona.

The locality of this claim with reference to some natural object or permanent monument and additional information (if any) concerning its locality are as follows: none

DATED AND POSTED on the ground this 4th day of September, 2020.

LOCATOR (s) Owner  
Arizona Assets, LLC

By Ron Parker

Ron Parker/Agent for Owners

AMC460988



# T9S R11E SECTION 8

## ARIZONA ASSETS AA CLAIM BLOCK

### AA8 CLAIM 01 THROUGH 32

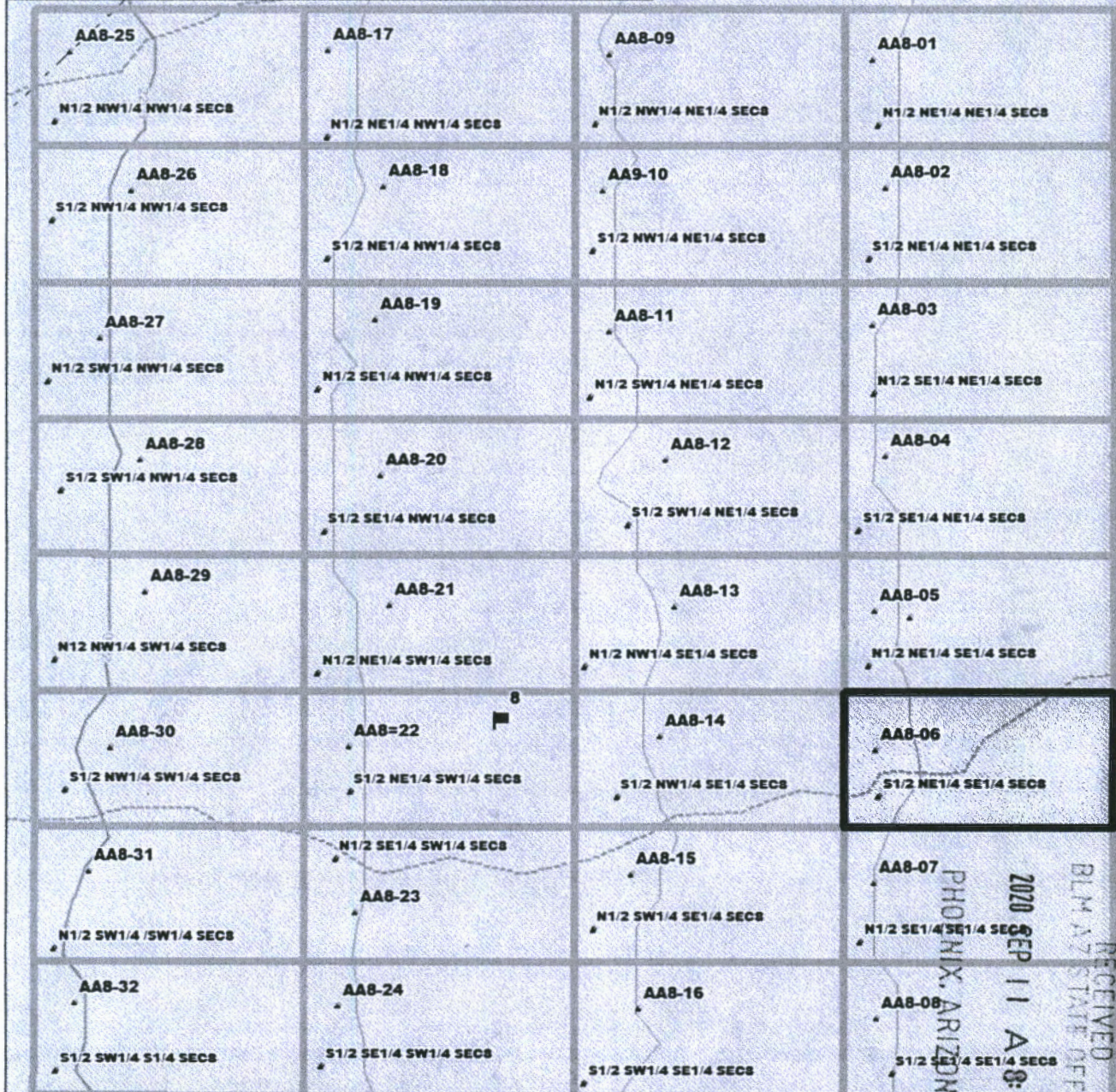

AMC460988

RECEIVED  
BLM AZ STATE OFFICE  
2020 SEP 11 AM 8:19  
PHOENIX, ARIZONA

Data use subject to license

© DeLorme. Topo North America™ 10.

www.delorme.com

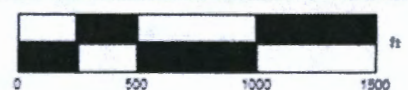

Data Zoom 14-3



**LOCATION NOTICE FOR PLACER MINING CLAIM**

NOTICE IS HEREBY GIVEN that the AA8-07 placer mining claim has been located by Arizona Assets, LLC whose current mailing address is 292 new river Cir., Henderson, Nevada 89052-2377

BLM	RECEIVED
DATE	BLM AZ STATE OFFICE
STAMP	2020 SEP 11 A 8:19
	PHOENIX, ARIZONA

The general course of this claim is East to West and is situated in Pinal County, Arizona.

The claim is 1,320 feet in length and 660 feet in width. This claim runs from the location monument on which the location notice is posted (being the northeast corner of the said claim), approximately 660 feet in a southerly direction to the south end line and 1,320 feet in a westerly direction to the west end line.

The claim is marked by four 2"x2"x4' monuments, one at each corner of the claim.

The location monument on which this notice is posted is situated within Section 8, Township 9 South, Range 11 East, Gila Salt River Base and Meridian, Arizona. This claim encompasses portions of the following quarter section (s), section (s), Township (s) and Range (s)

N 1/2 of the SE 1/4 of the SE 1/4 of Section 8, Township 9, Range 11 South, Gila Salt River Base and Meridian, Arizona.

The locality of this claim with reference to some natural object or permanent monument and additional information (if any) concerning its locality are as follows: none

DATED AND POSTED on the ground this 4th day of September, 2020.

LOCATOR (s) Owner  
Arizona Assets, LLC

By Ron Parker

Ron Parker/Agent for Owners

AMC460989



# T9S R11E SECTION 8

## ARIZONA ASSETS AA CLAIM BLOCK

### AA8 CLAIM 01 THROUGH 32

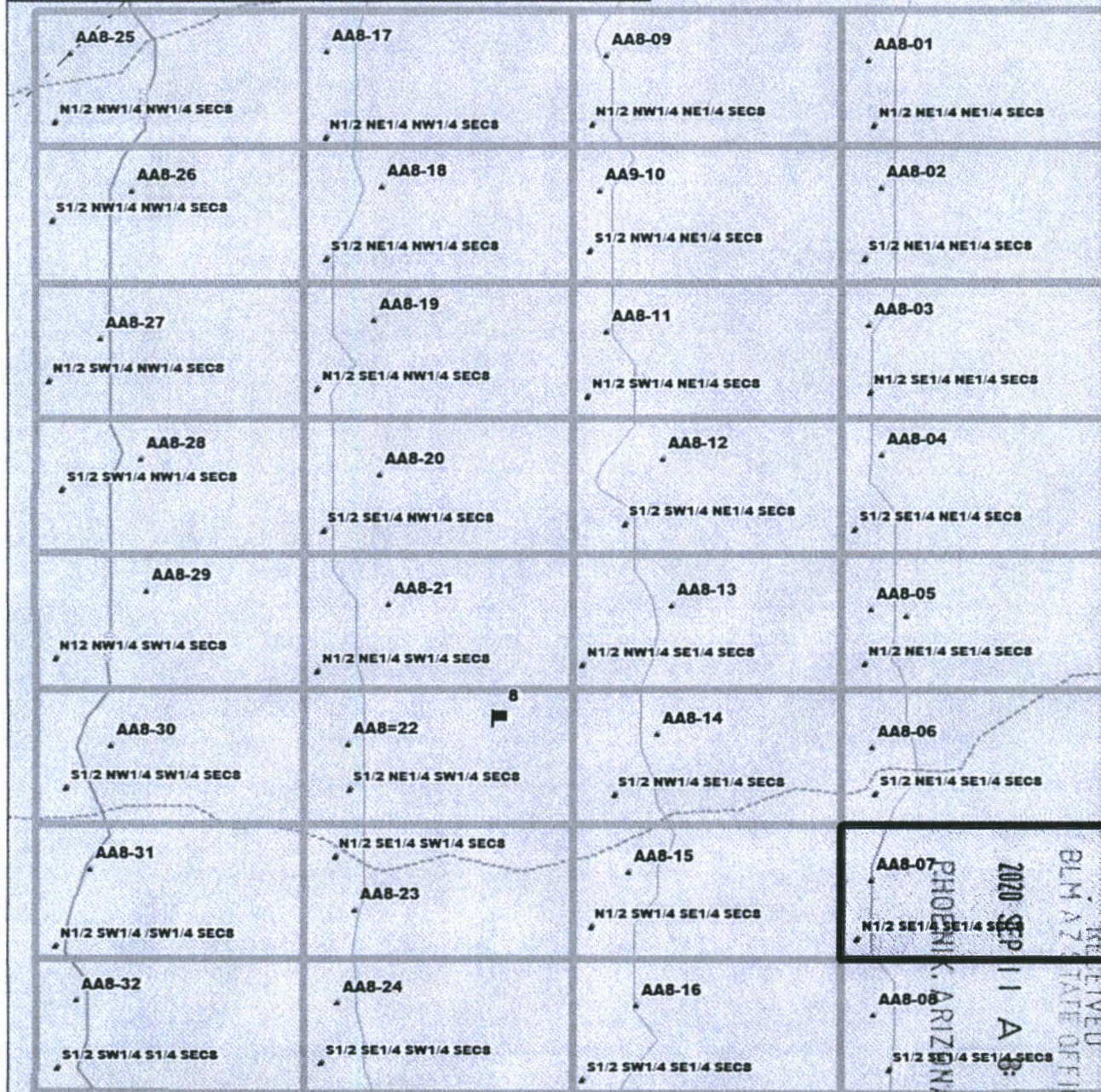

AMC460989

Data use subject to license.

© DeLorme. Topo North America™ 10.

www.delorme.com



MN (9.7° E)



Data Zoom 14-3



**LOCATION NOTICE FOR PLACER MINING CLAIM**

NOTICE IS HEREBY GIVEN that the AA8-08 placer mining claim has been located by Arizona Assets, LLC whose current mailing address is 292 new river Cir., Henderson, Nevada 89052-2377

BLM	RECEIVED
DATE	BLM AZ STATE OFFICE
STAMP	2020 SEP 11 A 8:19
	PHOENIX, ARIZONA

The general course of this claim is East to West and is situated in Pinal County, Arizona.

The claim is 1,320 feet in length and 660 feet in width. This claim runs from the location monument on which the location notice is posted (being the northeast corner of the said claim), approximately 660 feet in a southerly direction to the south end line and 1,320 feet in a westerly direction to the west end line.

The claim is marked by four 2"x2"x4' monuments, one at each corner of the claim.

The location monument on which this notice is posted is situated within Section 8, Township 9 South, Range 11 East, Gila Salt River Base and Meridian, Arizona. This claim encompasses portions of the following quarter section (s), section (s), Township (s) and Range (s)

S 1/2 of the SE 1/4 of the SE 1/4 of Section 8, Township 9, Range 11 South, Gila Salt River Base and Meridian, Arizona.

The locality of this claim with reference to some natural object or permanent monument and additional information (if any) concerning its locality are as follows: none

DATED AND POSTED on the ground this 4th day of September, 2020.

LOCATOR (s) Owner  
Arizona Assets, LLC

By Ron Parker

Ron Parker/Agent for Owners

AMC460990



# T9S R11E SECTION 8

## ARIZONA ASSETS AA CLAIM BLOCK

### AA8 CLAIM 01 THROUGH 32

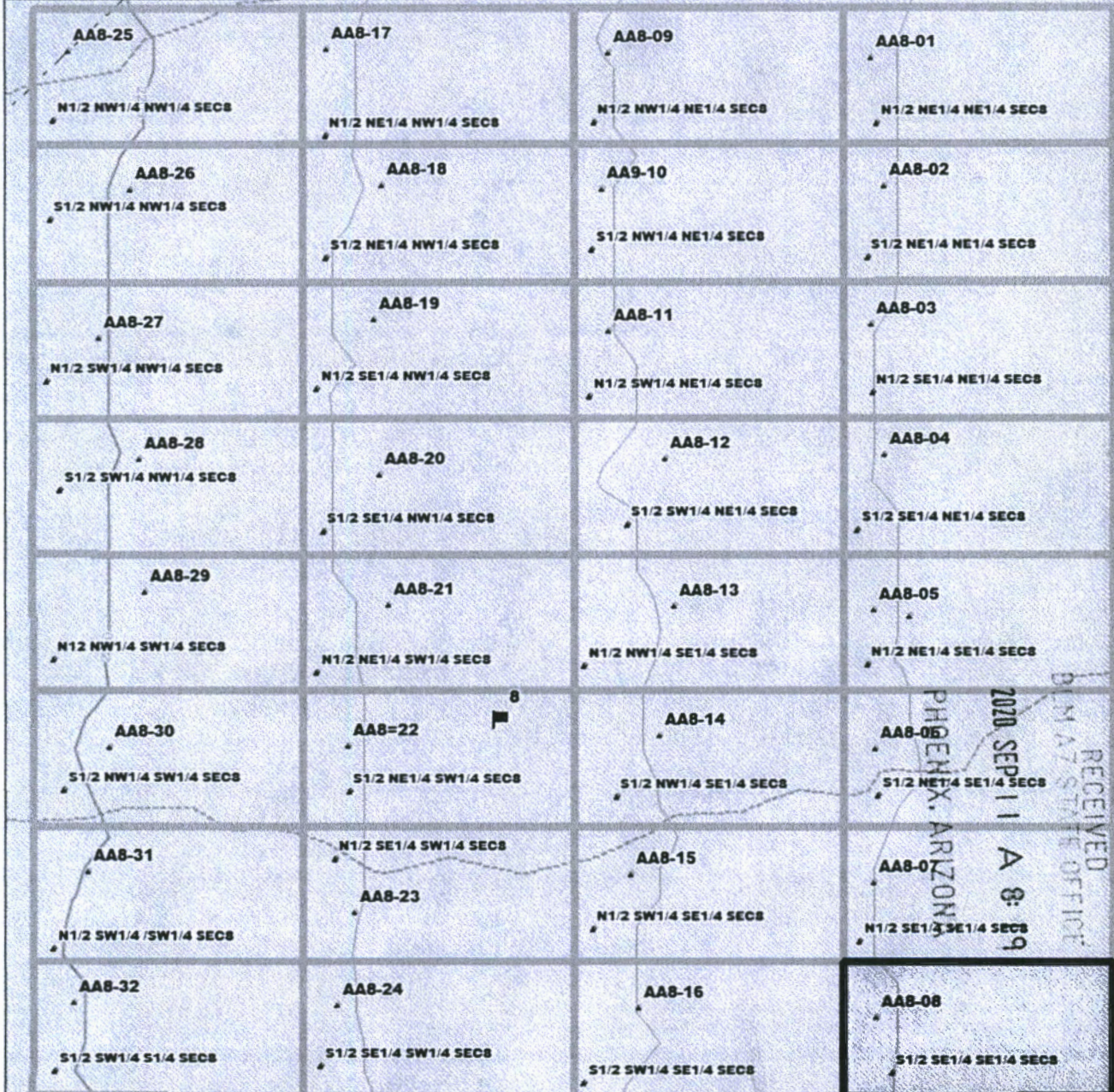

AMC460990

Data use subject to license

© DeLorme. Topo North America™ 10.

www.delorme.com

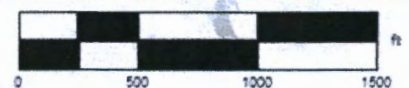

Data Zoom 14-3



**LOCATION NOTICE FOR PLACER MINING CLAIM**

NOTICE IS HEREBY GIVEN that the AA8-09 placer mining claim has been located by Arizona Assets, LLC whose current mailing address is 292 new river Cir., Henderson, Nevada 89052-2377

BLM	RECEIVED
DATE	BLM AZ STATE OFFICE
STAMP	2020 SEP 11 A 8:19
	PHOENIX, ARIZONA

The general course of this claim is East to West and is situated in Pinal County, Arizona.

The claim is 1,320 feet in length and 660 feet in width. This claim runs from the location monument on which the location notice is posted (being the northeast corner of the said claim), approximately 660 feet in a southerly direction to the south end line and 1,320 feet in a westerly direction to the west end line.

The claim is marked by four 2"x2"x4' monuments, one at each corner of the claim.

The location monument on which this notice is posted is situated within Section 8, Township 9 South, Range 11 East, Gila Salt River Base and Meridian, Arizona. This claim encompasses portions of the following quarter section (s), section (s), Township (s) and Range (s)

N 1/2 of the NW 1/4 of the NE 1/4 of Section 8, Township 9, Range 11 South, Gila Salt River Base and Meridian, Arizona.

The locality of this claim with reference to some natural object or permanent monument and additional information (if any) concerning its locality are as follows: none

DATED AND POSTED on the ground this 4th day of September, 2020.

LOCATOR (s) Owner  
Arizona Assets, LLC

By Ron Parker

Ron Parker/Agent for Owners

AMC460991



# T9S R11E SECTION 8

## ARIZONA ASSETS AA CLAIM BLOCK

### AA8 CLAIM 01 THROUGH 32

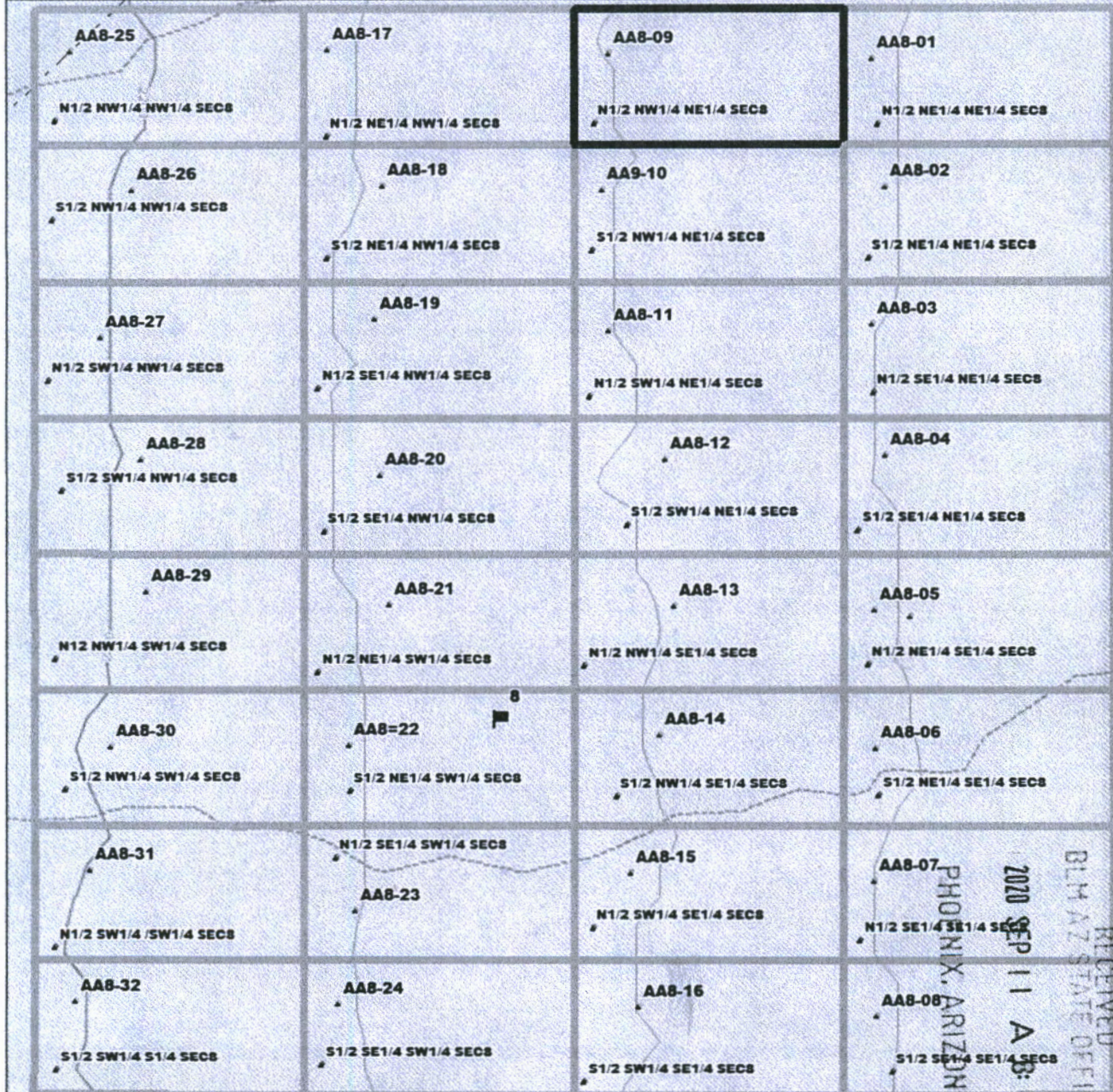

AMC460991

Data use subject to license

© DeLorme. Topo North America™ 10.

www.delorme.com

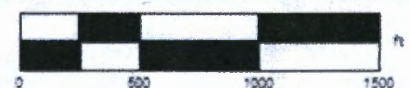

Data Zoom 14-3

RECEIVED  
BLM AZ STATE OFFICE  
2020 SEP 11 AM 1:19  
PHOENIX, ARIZONA



**LOCATION NOTICE FOR PLACER MINING CLAIM**

NOTICE IS HEREBY GIVEN that the AA8-10 placer mining claim has been located by Arizona Assets, LLC whose current mailing address is 292 new river Cir., Henderson, Nevada 89052-2377

BLM	RECEIVED
DATE	BLM AZ STATE OFFICE
STAMP	2020 SEP 11 A 8:19
	PHOENIX, ARIZONA

The general course of this claim is East to West and is situated in Pinal County, Arizona.

The claim is 1,320 feet in length and 660 feet in width. This claim runs from the location monument on which the location notice is posted (being the northeast corner of the said claim), approximately 660 feet in a southerly direction to the south end line and 1,320 feet in a westerly direction to the west end line.

The claim is marked by four 2"x2"x4' monuments, one at each corner of the claim.

The location monument on which this notice is posted is situated within Section 8, Township 9 South, Range 11 East, Gila Salt River Base and Meridian, Arizona. This claim encompasses portions of the following quarter section (s), section (s), Township (s) and Range (s)

S1/2 of the NW 1/4 of the NE 1/4 of Section 8, Township 9, Range 11 South, Gila Salt River Base and Meridian, Arizona.

The locality of this claim with reference to some natural object or permanent monument and additional information (if any) concerning its locality are as follows: none

DATED AND POSTED on the ground this 4th day of September, 2020.

LOCATOR (s) Owner  
Arizona Assets, LLC

By Ron Parker

Ron Parker/Agent for Owners

AMC460992

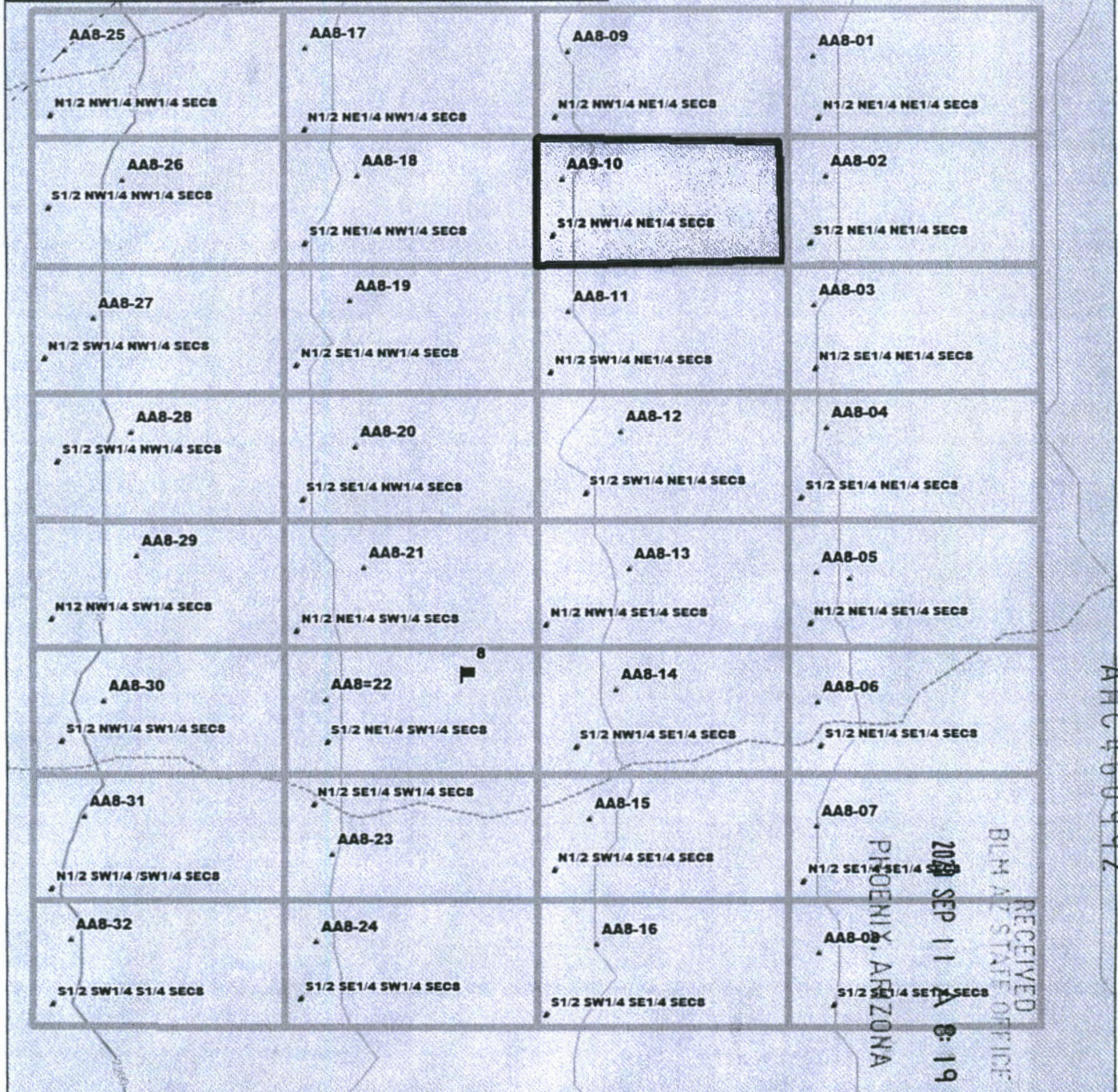

**T9S R11E SECTION 8****ARIZONA ASSETS AA CLAIM BLOCK****AA8 CLAIM 01 THROUGH 32**

Data use subject to license

© DeLorme. Topo North America™ 10.

www.delorme.com



MN (9.7° E)

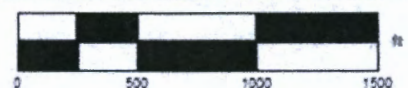

Data Zoom 14-3



**LOCATION NOTICE FOR PLACER MINING CLAIM**

NOTICE IS HEREBY GIVEN that the AA8-11 placer mining claim has been located by Arizona Assets, LLC whose current mailing address is 292 new river Cir., Henderson, Nevada 89052-2377

BLM	RECEIVED
DATE	BLM AZ STATE OFFICE
STAMP	2020 SEP 11 A 8:19
	PHOENIX, ARIZONA

The general course of this claim is East to West and is situated in Pinal County, Arizona.

The claim is 1,320 feet in length and 660 feet in width. This claim runs from the location monument on which the location notice is posted (being the northeast corner of the said claim), approximately 660 feet in a southerly direction to the south end line and 1,320 feet in a westerly direction to the west end line.

The claim is marked by four 2"x2"x4' monuments, one at each corner of the claim.

The location monument on which this notice is posted is situated within Section 8, Township 9 South, Range 11 East, Gila Salt River Base and Meridian, Arizona. This claim encompasses portions of the following quarter section (s), section (s), Township (s) and Range (s)

N 1/2 of the SW 1/4 of the NE 1/4 of Section 8, Township 9, Range 11 South, Gila Salt River Base and Meridian, Arizona.

The locality of this claim with reference to some natural object or permanent monument and additional information (if any) concerning its locality are as follows: none

DATED AND POSTED on the ground this 4th day of September, 2020.

LOCATOR (s) Owner  
Arizona Assets, LLC

By Ron Parker

Ron Parker/Agent for Owners

AMC460993

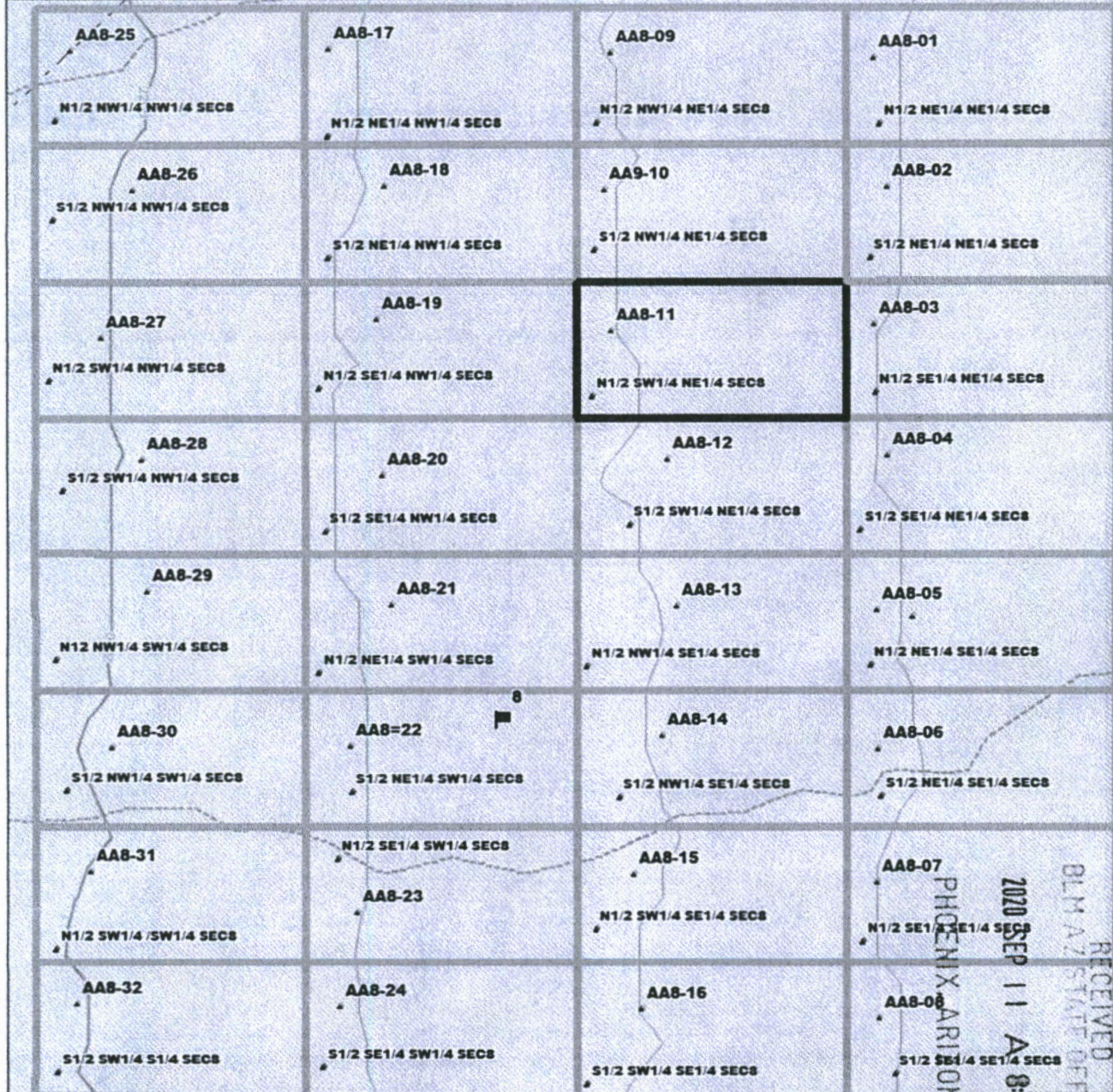

**T9S R11E SECTION 8****ARIZONA ASSETS AA CLAIM BLOCK****AA8 CLAIM 01 THROUGH 32**

AMC460993

RECEIVED  
BLM AZ STATE OFFICE  
2020 SEP 11 A 8:19  
PHOENIX ARIZONA

Data use subject to license.

© DeLorme. Topo North America™ 10.

www.delorme.com

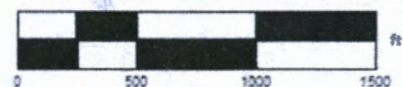

Data Zoom 14-3



**LOCATION NOTICE FOR PLACER MINING CLAIM**

NOTICE IS HEREBY GIVEN that the AA8-12 placer mining claim has been located by Arizona Assets, LLC whose current mailing address is 292 new river Cir., Henderson, Nevada 89052-2377

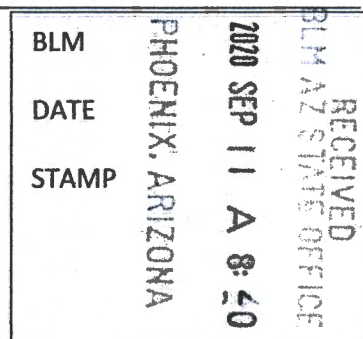

The general course of this claim is East to West and is situated in Pinal County, Arizona.

The claim is 1,320 feet in length and 660 feet in width. This claim runs from the location monument on which the location notice is posted (being the northeast corner of the said claim), approximately 660 feet in a southerly direction to the south end line and 1,320 feet in a westerly direction to the west end line.

The claim is marked by four 2"x2"x4' monuments, one at each corner of the claim.

The location monument on which this notice is posted is situated within Section 8, Township 9 South, Range 11 East, Gila Salt River Base and Meridian, Arizona. This claim encompasses portions of the following quarter section (s), section (s), Township (s) and Range (s)

S 1/2 of the NW 1/4 of the NE 1/4 of Section 8, Township 9, Range 11 South, Gila Salt River Base and Meridian, Arizona.

The locality of this claim with reference to some natural object or permanent monument and additional information (if any) concerning its locality are as follows: none

DATED AND POSTED on the ground this 4th day of September, 2020.

LOCATOR (s) Owner  
Arizona Assets, LLC

By Ron Parker

Ron Parker/Agent for Owners

AMC 460994



# T9S R11E SECTION 8

## ARIZONA ASSETS AA CLAIM BLOCK

### AA8 CLAIM 01 THROUGH 32



Data use subject to license.

© DeLorme. Topo North America™ 10.

www.delorme.com

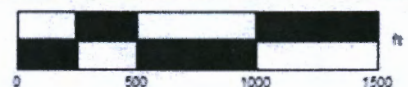

Data Zoom 14-3



**LOCATION NOTICE FOR PLACER MINING CLAIM**

NOTICE IS HEREBY GIVEN that the AA8-13 placer mining claim has been located by Arizona Assets, LLC whose current mailing address is 292 new river Cir., Henderson, Nevada 89052-2377

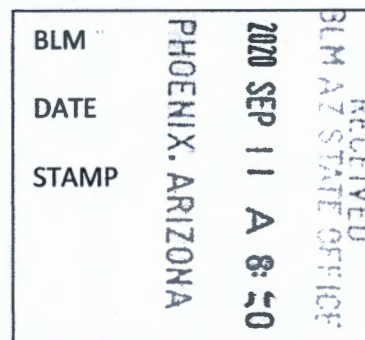

The general course of this claim is East to West and is situated in Pinal County, Arizona.

The claim is 1,320 feet in length and 660 feet in width. This claim runs from the location monument on which the location notice is posted (being the northeast corner of the said claim), approximately 660 feet in a southerly direction to the south end line and 1,320 feet in a westerly direction to the west end line.

The claim is marked by four 2"x2"x4' monuments, one at each corner of the claim.

The location monument on which this notice is posted is situated within Section 8, Township 9 South, Range 11 East, Gila Salt River Base and Meridian, Arizona. This claim encompasses portions of the following quarter section (s), section (s), Township (s) and Range (s)

N 1/2 of the NW 1/4 of the SE 1/4 of Section 8, Township 9, Range 11 South, Gila Salt River Base and Meridian, Arizona.

The locality of this claim with reference to some natural object or permanent monument and additional information (if any) concerning its locality are as follows: none

DATED AND POSTED on the ground this 4th day of September, 2020.

LOCATOR (s) Owner  
Arizona Assets, LLC

By 

Ron Parker/Agent for Owners

AMC460995



# T9S R11E SECTION 8

## ARIZONA ASSETS AA CLAIM BLOCK

### AA8 CLAIM 01 THROUGH 32

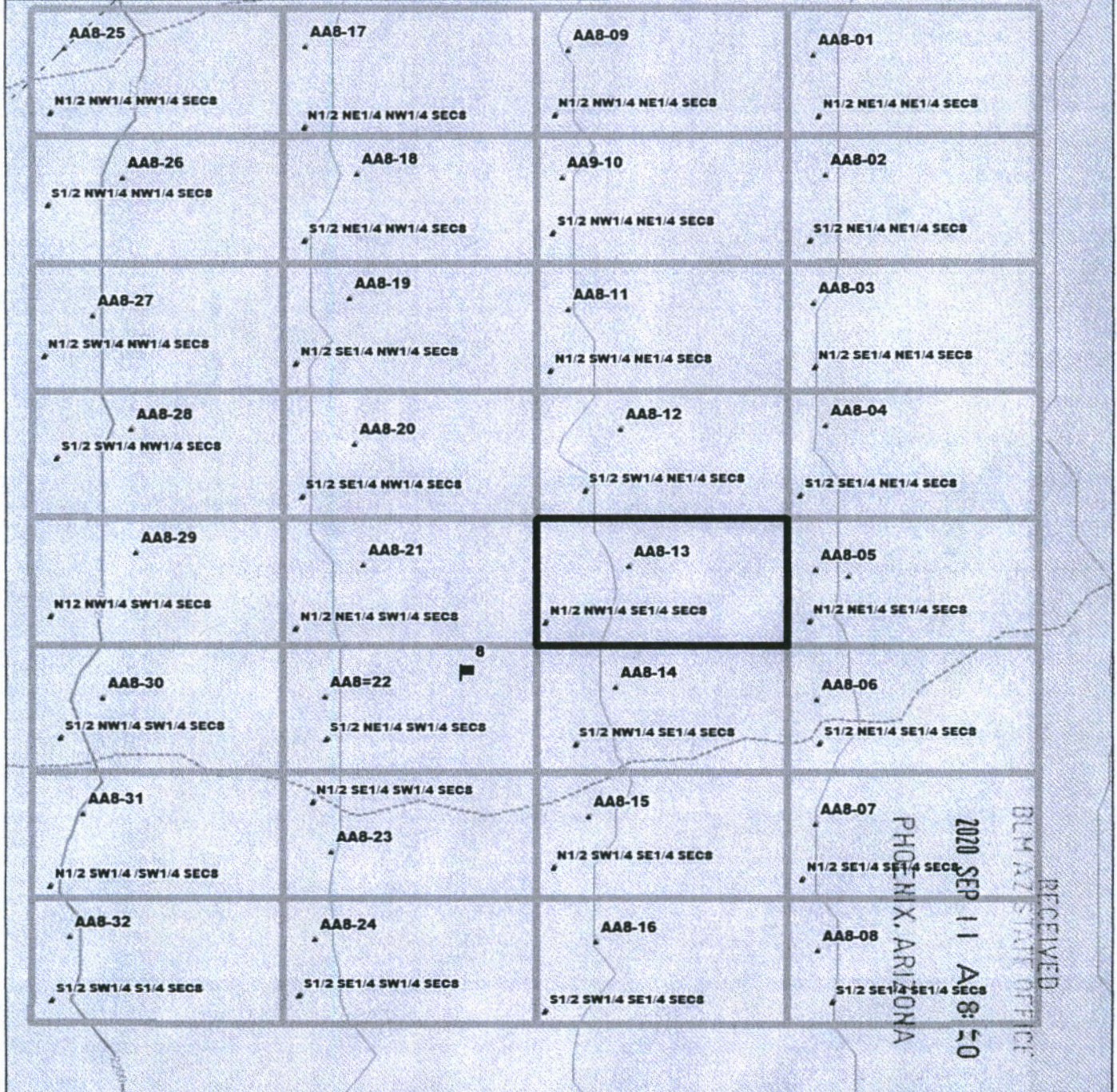

AMC460995

Data use subject to license

© DeLorme. Topo North America™ 10.

www.delorme.com

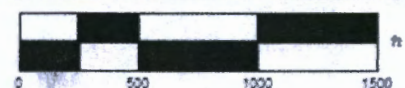

Data Zoom 14-3



**LOCATION NOTICE FOR PLACER MINING CLAIM**

NOTICE IS HEREBY GIVEN that the AA8-14 placer mining claim has been located by Arizona Assets, LLC whose current mailing address is 292 new river Cir., Henderson, Nevada 89052-2377

BLM	2020 SEP 11 A 8:20	RECEIVED
DATE	PHOENIX, ARIZONA	BLM AZ STATE OFFICE
STAMP		

The general course of this claim is East to West and is situated in Pinal County, Arizona.

The claim is 1,320 feet in length and 660 feet in width. This claim runs from the location monument on which the location notice is posted (being the northeast corner of the said claim), approximately 660 feet in a southerly direction to the south end line and 1,320 feet in a westerly direction to the west end line.

The claim is marked by four 2"x2"x4' monuments, one at each corner of the claim.

The location monument on which this notice is posted is situated within Section 8, Township 9 South, Range 11 East, Gila Salt River Base and Meridian, Arizona. This claim encompasses portions of the following quarter section (s), section (s), Township (s) and Range (s)

S 1/2 of the NW 1/4 of the SE 1/4 of Section 8, Township 9, Range 11 South, Gila Salt River Base and Meridian, Arizona.

The locality of this claim with reference to some natural object or permanent monument and additional information (if any) concerning its locality are as follows: none

DATED AND POSTED on the ground this 4th day of September, 2020.

LOCATOR (s) Owner  
Arizona Assets, LLC

By Ron Parker

Ron Parker/Agent for Owners

AMC460996



# T9S R11E SECTION 8

## ARIZONA ASSETS AA CLAIM BLOCK

### AA8 CLAIM 01 THROUGH 32

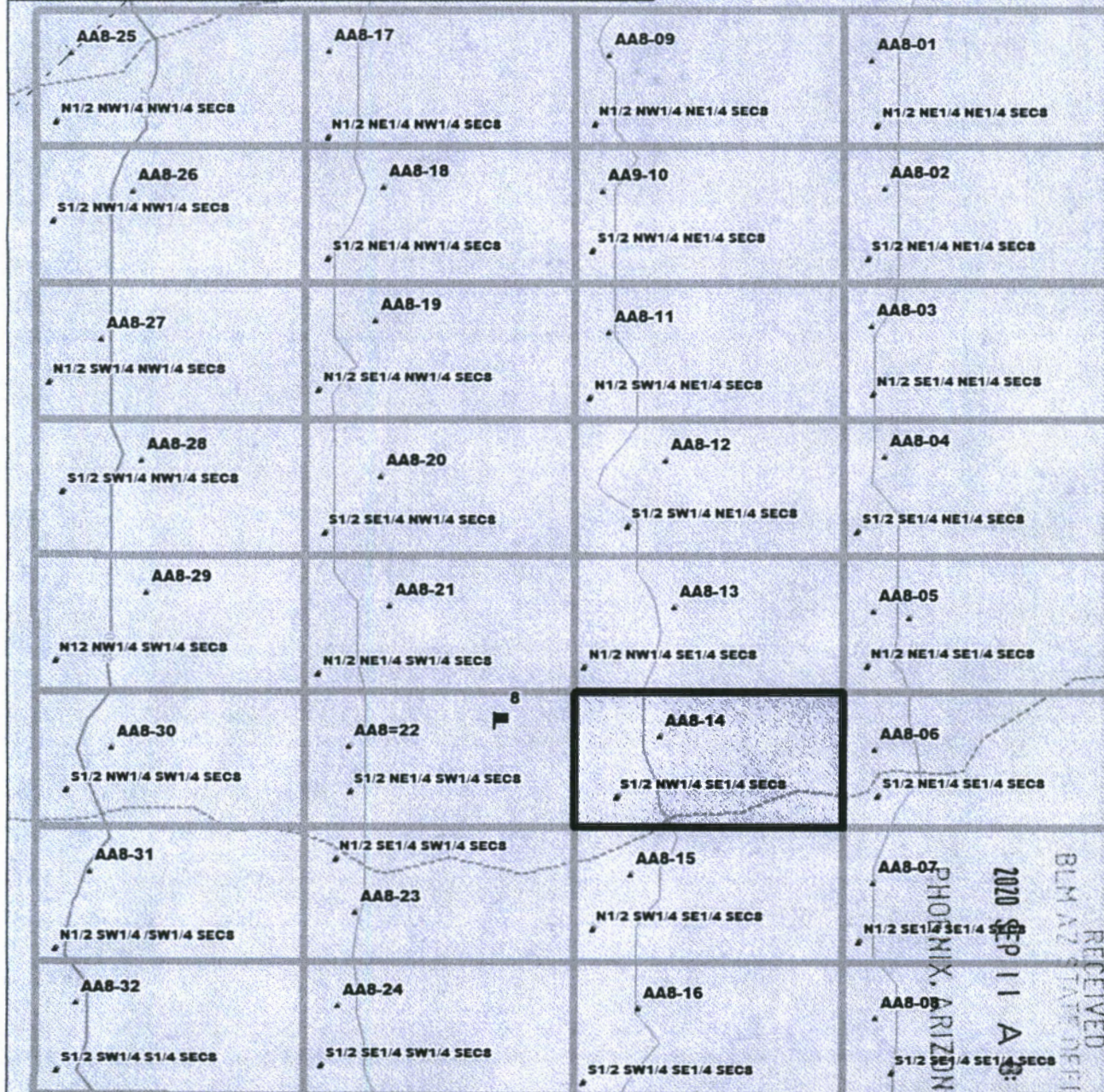

AN C460996

Data use subject to license.

© DeLorme. Topo North America™ 10.

www.delorme.com

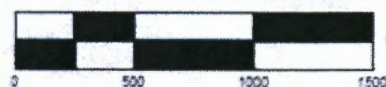

Data Zoom 14-3



**LOCATION NOTICE FOR PLACER MINING CLAIM**

NOTICE IS HEREBY GIVEN that the AA8-15 placer mining claim has been located by Arizona Assets, LLC whose current mailing address is 292 new river Cir., Henderson, Nevada 89052-2377

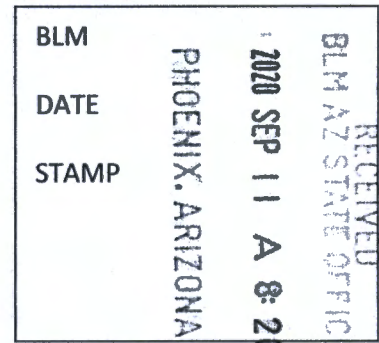

The general course of this claim is East to West and is situated in Pinal County, Arizona.

The claim is 1,320 feet in length and 660 feet in width. This claim runs from the location monument on which the location notice is posted (being the northeast corner of the said claim), approximately 660 feet in a southerly direction to the south end line and 1,320 feet in a westerly direction to the west end line.

The claim is marked by four 2"x2"x4' monuments, one at each corner of the claim.

The location monument on which this notice is posted is situated within Section 8, Township 9 South, Range 11 East, Gila Salt River Base and Meridian, Arizona. This claim encompasses portions of the following quarter section (s), section (s), Township (s) and Range (s)

N 1/2 of the SW 1/4 of the SE 1/4 of the East 1/2 of Section 8, Township 9, Range 11 South, Gila Salt River Base and Meridian, Arizona.

The locality of this claim with reference to some natural object or permanent monument and additional information (if any) concerning its locality are as follows: none

DATED AND POSTED on the ground this 4th day of September, 2020.

LOCATOR (s) Owner  
Arizona Assets, LLC

By Ron Parker

Ron Parker/Agent for Owners

AMC460997



# T9S R11E SECTION 8

## ARIZONA ASSETS AA CLAIM BLOCK

### AA8 CLAIM 01 THROUGH 32

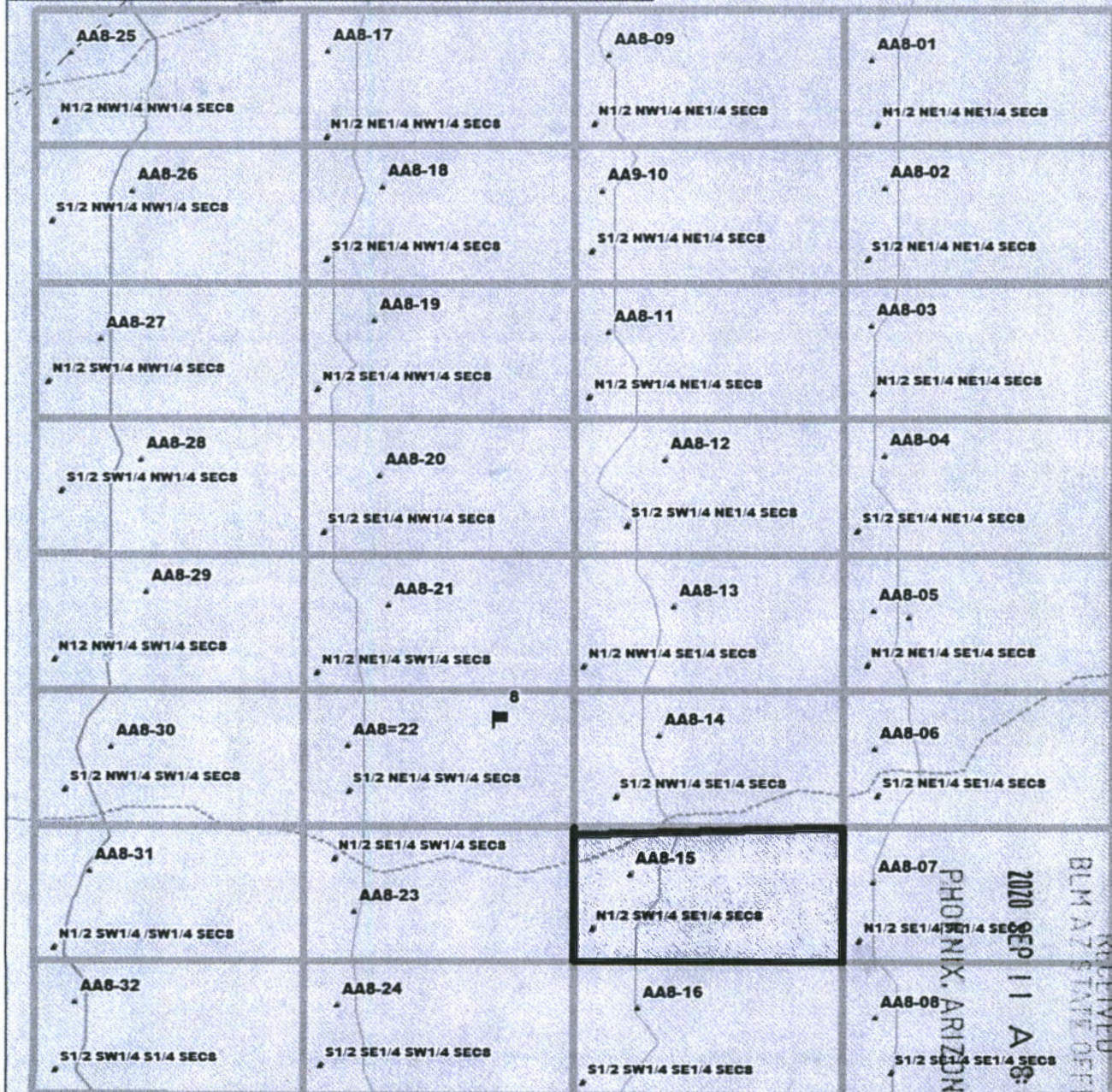

AMC460997

PHOENIX, ARIZONA

2020 SEP 11 A 8:20

RECEIVED  
BLM AZ STATE OFFICE

Data use subject to license

© DeLorme. Topo North America™ 10.

www.delorme.com

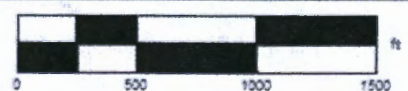

Data Zoom 14-3



**LOCATION NOTICE FOR PLACER MINING CLAIM**

NOTICE IS HEREBY GIVEN that the AA8-16 placer mining claim has been located by Arizona Assets, LLC whose current mailing address is 292 new river Cir., Henderson, Nevada 89052-2377

BLM	RECEIVED
DATE	BLM AZ STATE OFFICE
STAMP	2020 SEP 11 A 8:20
	PHOENIX, ARIZONA

The general course of this claim is East to West and is situated in Pinal County, Arizona.

The claim is 1,320 feet in length and 660 feet in width. This claim runs from the location monument on which the location notice is posted (being the northeast corner of the said claim), approximately 660 feet in a southerly direction to the south end line and 1,320 feet in a westerly direction to the west end line.

The claim is marked by four 2"x2"x4' monuments, one at each corner of the claim.

The location monument on which this notice is posted is situated within Section 8, Township 9 South, Range 11 East, Gila Salt River Base and Meridian, Arizona. This claim encompasses portions of the following quarter section (s), section (s), Township (s) and Range (s)

S 1/2 of the SW 1/4 of the SE 1/4 of Section 8, Township 9, Range 11 South, Gila Salt River Base and Meridian, Arizona.

The locality of this claim with reference to some natural object or permanent monument and additional information (if any) concerning its locality are as follows: none

DATED AND POSTED on the ground this 4th day of September, 2020.

LOCATOR (s) Owner  
Arizona Assets, LLC

By Ron Parker

Ron Parker/Agent for Owners

AMC460998



# T9S R11E SECTION 8

## ARIZONA ASSETS AA CLAIM BLOCK

### AA8 CLAIM 01 THROUGH 32

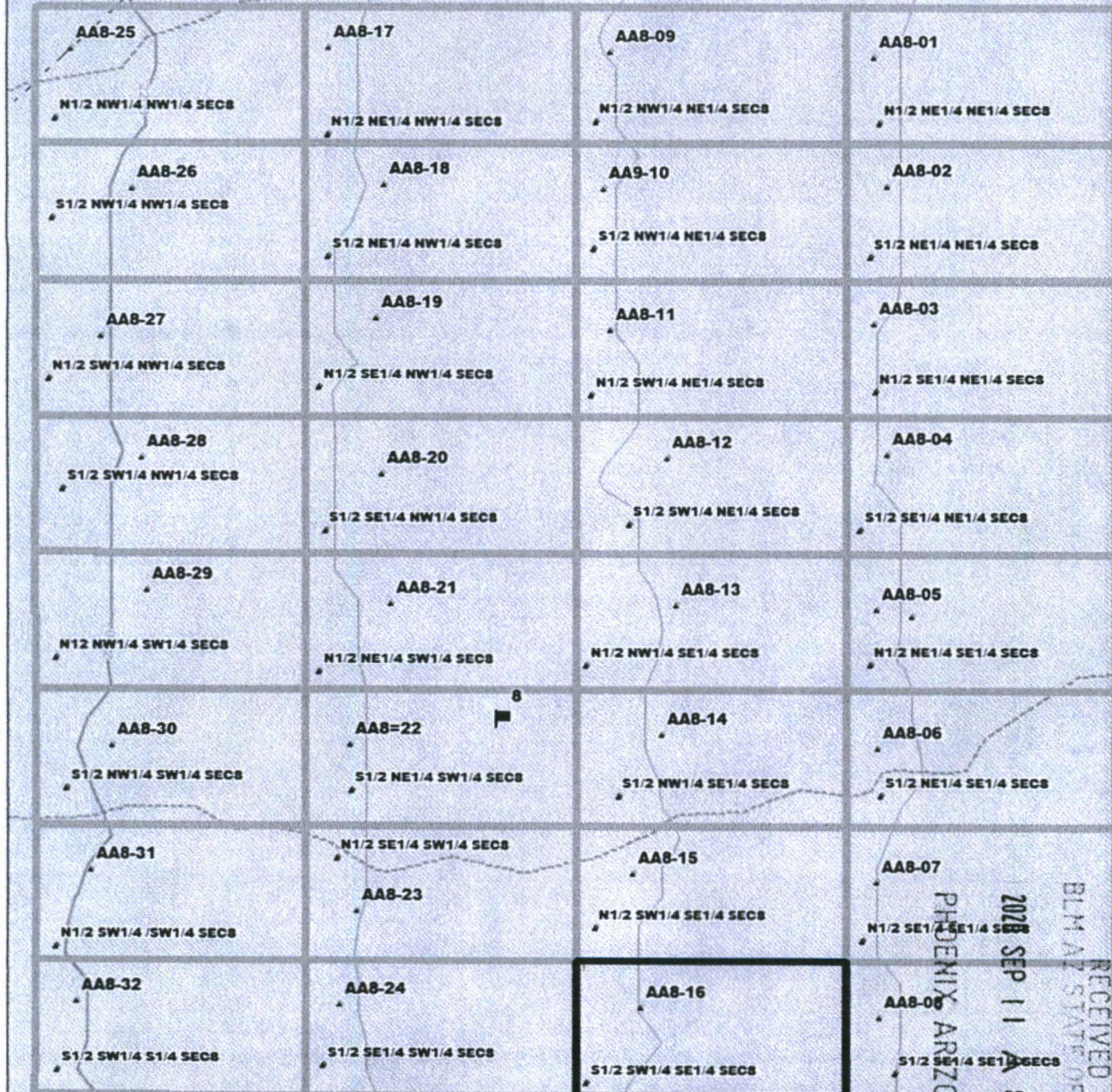

AMC460998

RECEIVED  
BLM AZ STATE OFFICE  
2028 SEP 11 8:20  
PHOENIX ARIZONA

Data use subject to license.

© DeLorme. Topo North America™ 10.

www.delorme.com

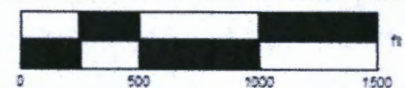

Data Zoom 14-3



**LOCATION NOTICE FOR PLACER MINING CLAIM**

NOTICE IS HEREBY GIVEN that the AA8-17 placer mining claim has been located by Arizona Assets, LLC whose current mailing address is 292 new river Cir., Henderson, Nevada 89052-2377

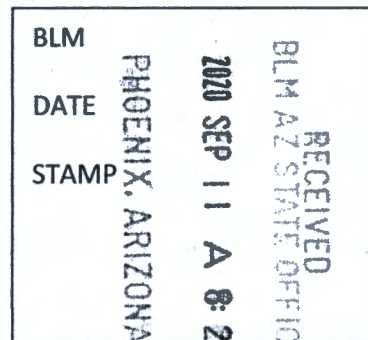

The general course of this claim is East to West and is situated in Pinal County, Arizona.

The claim is 1,320 feet in length and 660 feet in width. This claim runs from the location monument on which the location notice is posted (being the northeast corner of the said claim), approximately 660 feet in a southerly direction to the south end line and 1,320 feet in a westerly direction to the west end line.

The claim is marked by four 2"x2"x4' monuments, one at each corner of the claim.

The location monument on which this notice is posted is situated within Section 8, Township 9 South, Range 11 East, Gila Salt River Base and Meridian, Arizona. This claim encompasses portions of the following quarter section (s), section (s), Township (s) and Range (s)

N 1/2 of the NE 1/4 of the NW 1/4 of Section 8, Township 9, Range 11 South, Gila Salt River Base and Meridian, Arizona.

The locality of this claim with reference to some natural object or permanent monument and additional information (if any) concerning its locality are as follows: none

DATED AND POSTED on the ground this 4th day of September, 2020.

LOCATOR (s) Owner  
Arizona Assets, LLC

By Ron Parker

Ron Parker/Agent for Owners

AMC460999



# T9S R11E SECTION 8

## ARIZONA ASSETS AA CLAIM BLOCK

### AA8 CLAIM 01 THROUGH 32

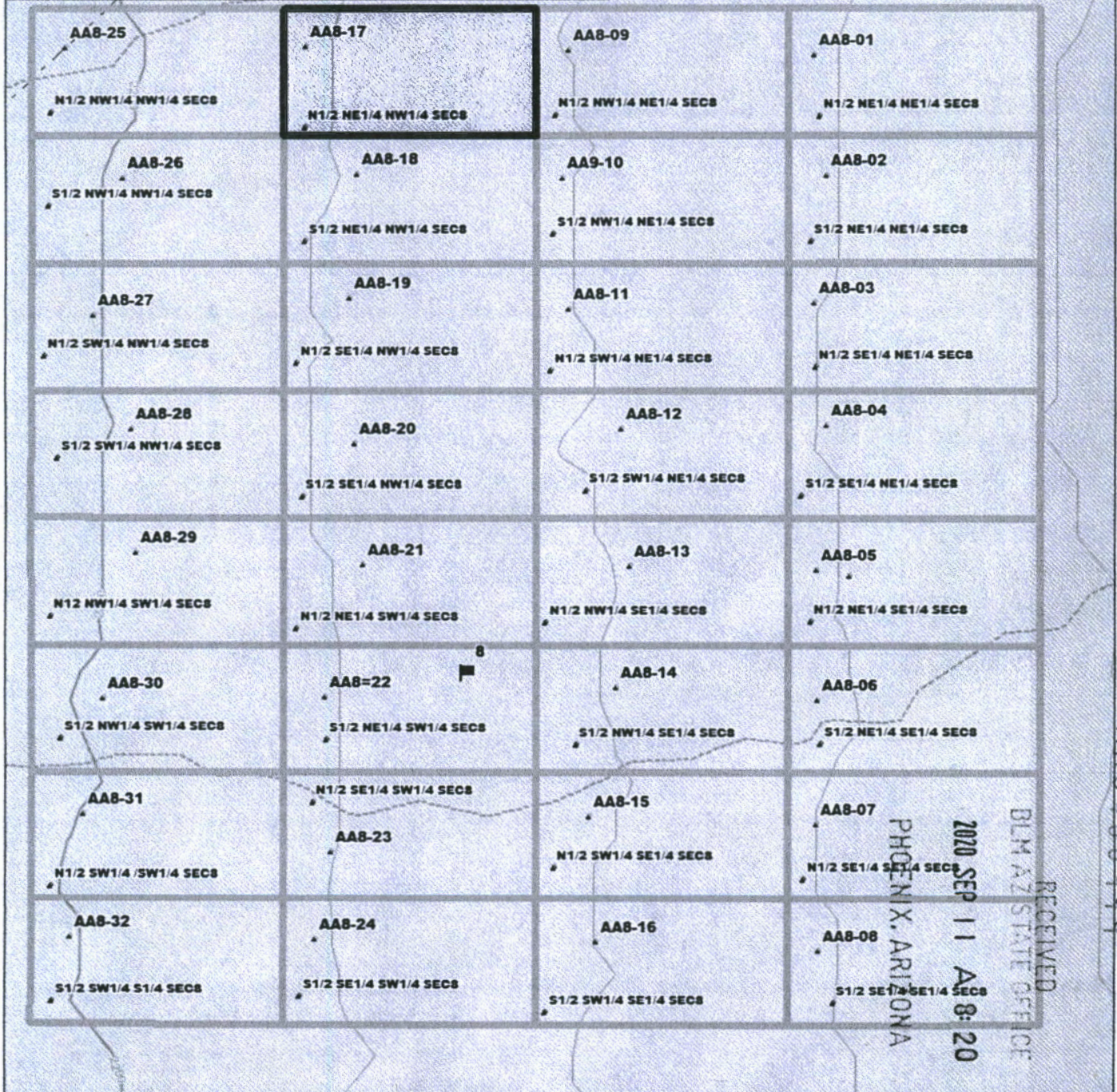

Data use subject to license

© DeLorme. Topo North America™ 10.

www.delorme.com



**LOCATION NOTICE FOR PLACER MINING CLAIM**

NOTICE IS HEREBY GIVEN that the AA8-18 placer mining claim has been located by Arizona Assets, LLC whose current mailing address is 292 new river Cir., Henderson, Nevada 89052-2377

BLM	RECEIVED
DATE	BLM AZ STATE OFFICE
STAMP	2020 SEP 11 A 8:20
	PHOENIX, ARIZONA

The general course of this claim is East to West and is situated in Pinal County, Arizona.

The claim is 1,320 feet in length and 660 feet in width. This claim runs from the location monument on which the location notice is posted (being the northeast corner of the said claim), approximately 660 feet in a southerly direction to the south end line and 1,320 feet in a westerly direction to the west end line.

The claim is marked by four 2"x2"x4' monuments, one at each corner of the claim.

The location monument on which this notice is posted is situated within Section 8, Township 9 South, Range 11 East, Gila Salt River Base and Meridian, Arizona. This claim encompasses portions of the following quarter section (s), section (s), Township (s) and Range (s)

S 1/2 of the NE 1/4 of the NW 1/4 of Section 8, Township 9, Range 11 South, Gila Salt River Base and Meridian, Arizona.

The locality of this claim with reference to some natural object or permanent monument and additional information (if any) concerning its locality are as follows: none

DATED AND POSTED on the ground this 4th day of September, 2020.

LOCATOR (s) Owner  
Arizona Assets, LLC

By Ron Parker

Ron Parker/Agent for Owners

AMC461000

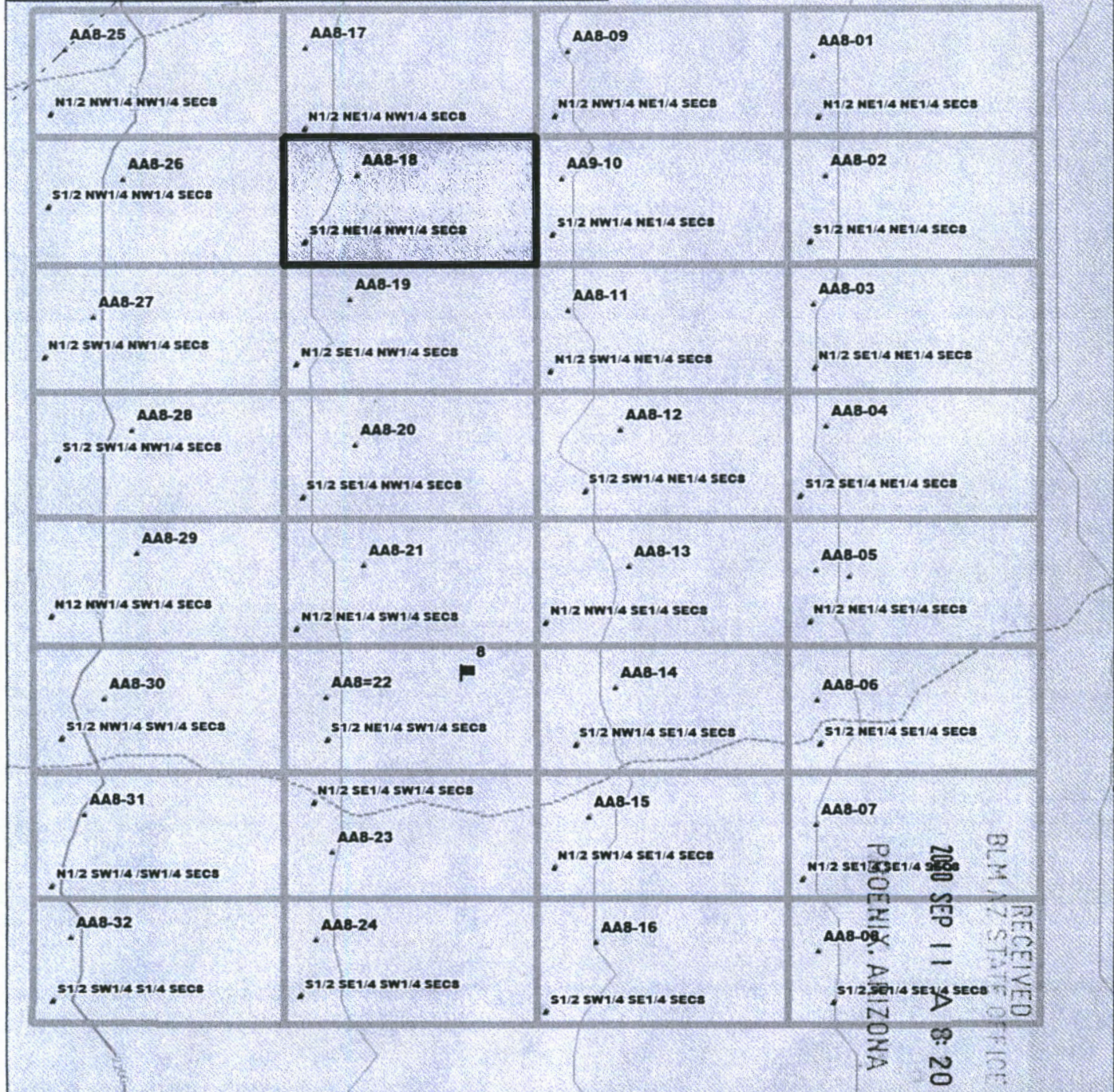

**T9S R11E SECTION 8****ARIZONA ASSETS AA CLAIM BLOCK****AA8 CLAIM 01 THROUGH 32**

Data use subject to license

© DeLorme. Topo North America™ 10.

www.delorme.com

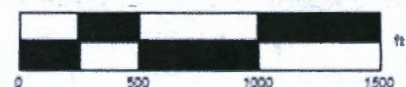

Data Zoom 14-3



**LOCATION NOTICE FOR PLACER MINING CLAIM**

NOTICE IS HEREBY GIVEN that the AA8-19 placer mining claim has been located by Arizona Assets, LLC whose current mailing address is 292 new river Cir., Henderson, Nevada 89052-2377

BLM	RECEIVED
DATE	BLM AZ STATE OFFICE
STAMP	2020 SEP 11 A 8:20
	PHOENIX, ARIZONA

The general course of this claim is East to West and is situated in Pinal County, Arizona.

The claim is 1,320 feet in length and 660 feet in width. This claim runs from the location monument on which the location notice is posted (being the northeast corner of the said claim), approximately 660 feet in a southerly direction to the south end line and 1,320 feet in a westerly direction to the west end line.

The claim is marked by four 2"x2"x4' monuments, one at each corner of the claim.

The location monument on which this notice is posted is situated within Section 8, Township 9 South, Range 11 East, Gila Salt River Base and Meridian, Arizona. This claim encompasses portions of the following quarter section (s), section (s), Township (s) and Range (s)

N 1/2 of the SE 1/4 of the NW 1/4 of Section 8, Township 9, Range 11 South, Gila Salt River Base and Meridian, Arizona.

The locality of this claim with reference to some natural object or permanent monument and additional information (if any) concerning its locality are as follows: none

DATED AND POSTED on the ground this 4th day of September, 2020.

LOCATOR (s) Owner  
Arizona Assets, LLC

By Ron Parker

Ron Parker/Agent for Owners

AMC461001



# T9S R11E SECTION 8

## ARIZONA ASSETS AA CLAIM BLOCK

### AA8 CLAIM 01 THROUGH 32

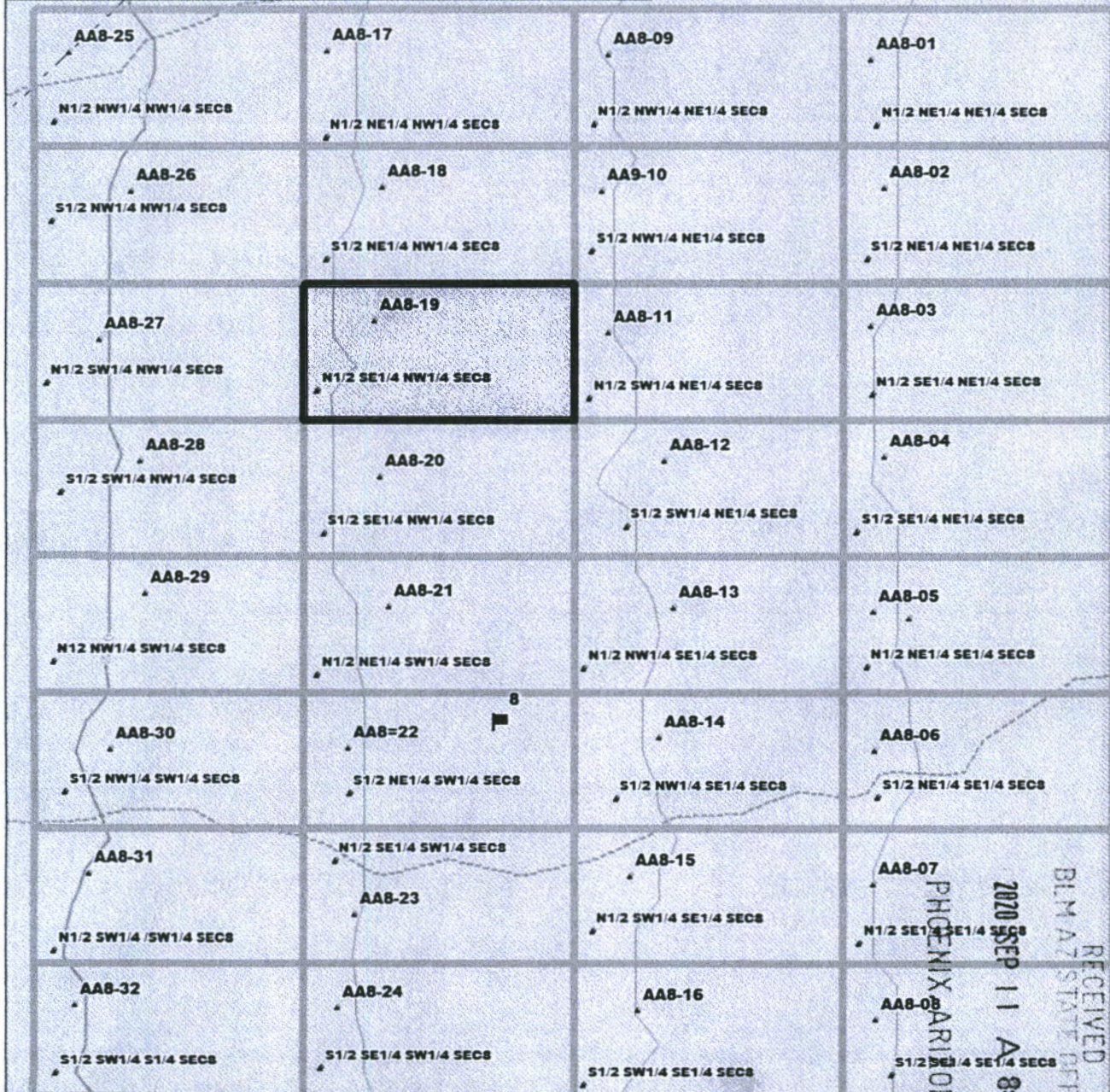

AMC461001

RECEIVED  
BLM AZ STATE OFFICE  
2020 SEP 11 A 8:21  
PHOENIX ARIZONA

Data use subject to license.

© DeLorme. Topo North America™ 10.

www.delorme.com

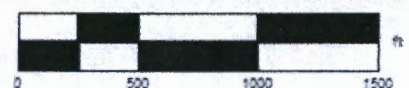

Data Zoom 14-3



**LOCATION NOTICE FOR PLACER MINING CLAIM**

NOTICE IS HEREBY GIVEN that the AA8-20 placer mining claim has been located by Arizona Assets, LLC whose current mailing address is 292 new river Cir., Henderson, Nevada 89052-2377

BLM	RECEIVED
DATE	BLM AZ STATE OFFICE
STAMP	2020 SEP 11 A 8:21
	PHOENIX, ARIZONA

The general course of this claim is East to West and is situated in Pinal County, Arizona.

The claim is 1,320 feet in length and 660 feet in width. This claim runs from the location monument on which the location notice is posted (being the northeast corner of the said claim), approximately 660 feet in a southerly direction to the south end line and 1,320 feet in a westerly direction to the west end line.

The claim is marked by four 2"x2"x4' monuments, one at each corner of the claim.

The location monument on which this notice is posted is situated within Section 8, Township 9 South, Range 11 East, Gila Salt River Base and Meridian, Arizona. This claim encompasses portions of the following quarter section (s), section (s), Township (s) and Range (s)

S 1/2 of the SE 1/4 of the NW 1/4 of Section 8, Township 9, Range 11 South, Gila Salt River Base and Meridian, Arizona.

The locality of this claim with reference to some natural object or permanent monument and additional information (if any) concerning its locality are as follows: none

DATED AND POSTED on the ground this 4th day of September, 2020.

LOCATOR (s) Owner  
Arizona Assets, LLC

By Ron Parker

Ron Parker/Agent for Owners

AMC 461002



# T9S R11E SECTION 8

## ARIZONA ASSETS AA CLAIM BLOCK

### AA8 CLAIM 01 THROUGH 32

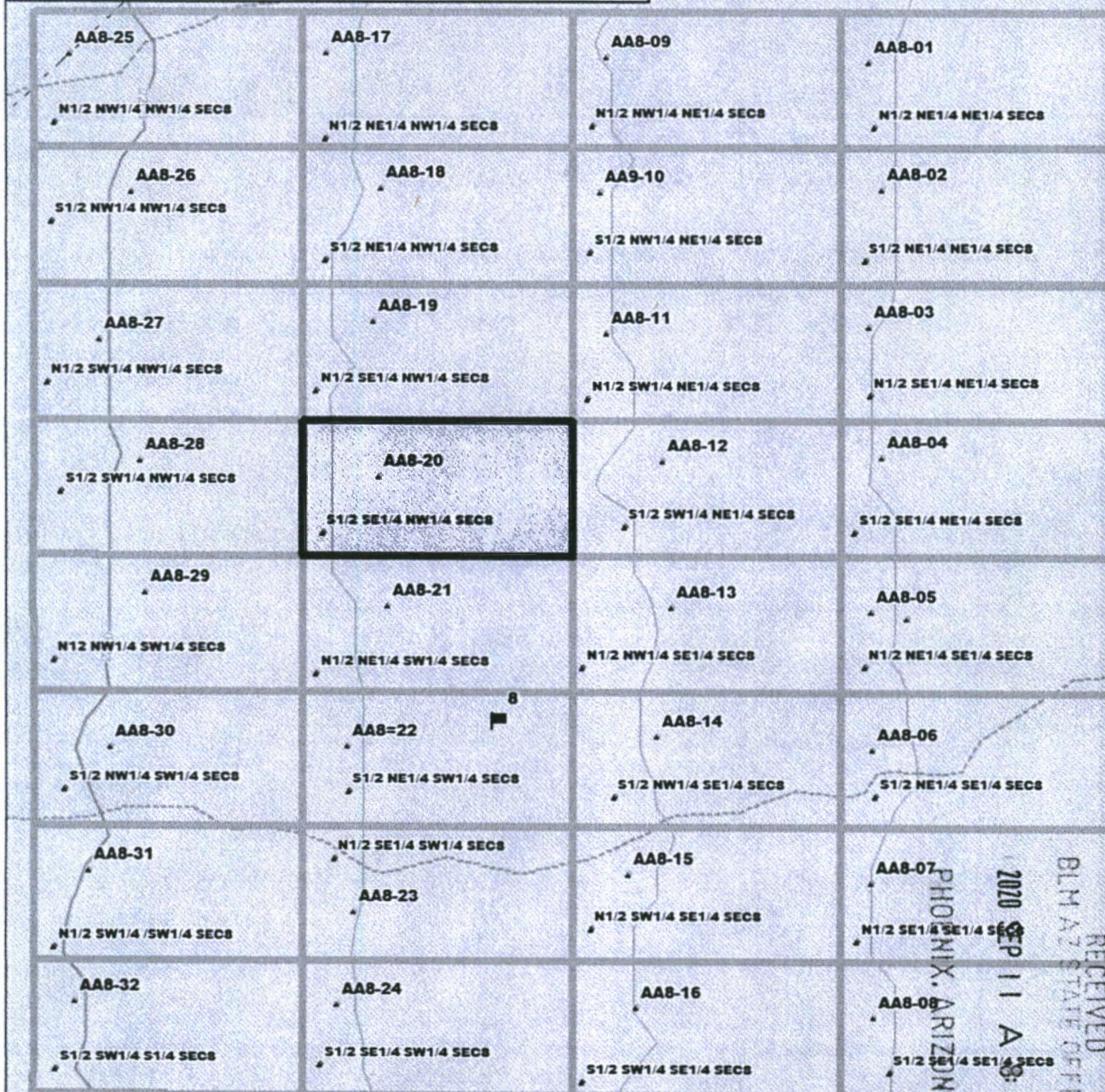

AMC461002

Data use subject to license

© DeLorme. Topo North America™ 10.

www.delorme.com

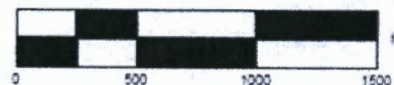

Data Zoom 14-3



**LOCATION NOTICE FOR PLACER MINING CLAIM**

NOTICE IS HEREBY GIVEN that the AA8-21 placer mining claim has been located by Arizona Assets, LLC whose current mailing address is 292 new river Cir., Henderson, Nevada 89052-2377

BLM	RECEIVED
DATE	BLM AZ STATE OFFICE
STAMP	2020 SEP 11 A 8:21
	PHOENIX, ARIZONA

The general course of this claim is East to West and is situated in Pinal County, Arizona.

The claim is 1,320 feet in length and 660 feet in width. This claim runs from the location monument on which the location notice is posted (being the northeast corner of the said claim), approximately 660 feet in a southerly direction to the south end line and 1,320 feet in a westerly direction to the west end line.

The claim is marked by four 2"x2"x4' monuments, one at each corner of the claim.

The location monument on which this notice is posted is situated within Section 8, Township 9 South, Range 11 East, Gila Salt River Base and Meridian, Arizona. This claim encompasses portions of the following quarter section (s), section (s), Township (s) and Range (s)

N 1/2 of the NE 1/4 SW 1/4 of Section 8, Township 9, Range 11 South, Gila Salt River Base and Meridian, Arizona.

The locality of this claim with reference to some natural object or permanent monument and additional information (if any) concerning its locality are as follows: none

DATED AND POSTED on the ground this 4th day of September, 2020.

LOCATOR (s) Owner  
Arizona Assets, LLC

By Ron Parker

Ron Parker/Agent for Owners

AMC461003



# T9S R11E SECTION 8

## ARIZONA ASSETS AA CLAIM BLOCK

### AA8 CLAIM 01 THROUGH 32

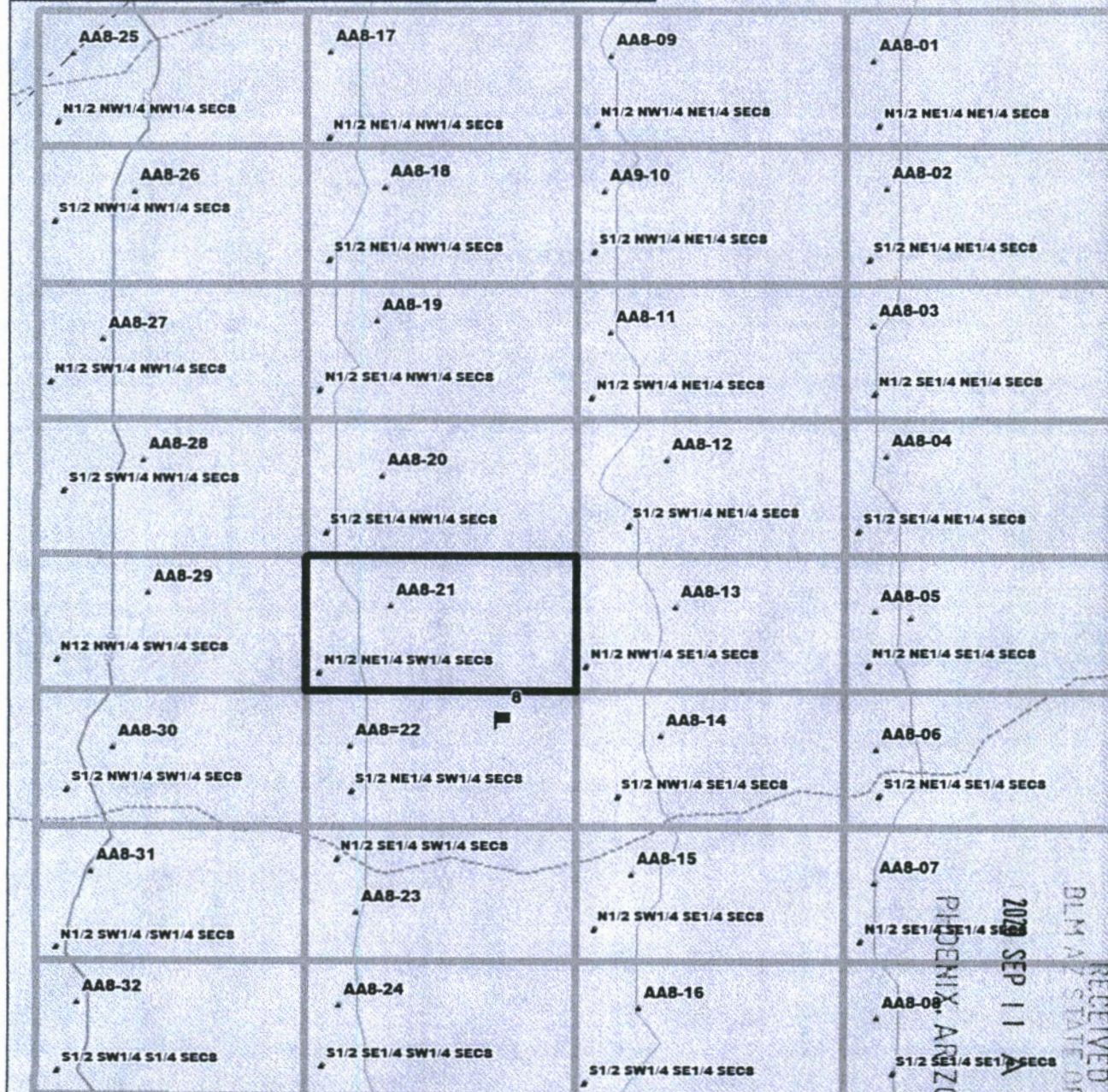

Data use subject to license.

© DeLorme. Topo North America™ 10.

www.delorme.com

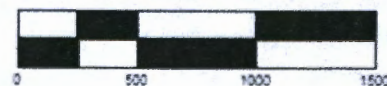

Data Zoom 14-3

AHC461003

RECEIVED  
 BLM ARIZONA STATE OFFICE  
 2009 SEP 11 A 8:21  
 PHOENIX ARIZONA



**LOCATION NOTICE FOR PLACER MINING CLAIM**

NOTICE IS HEREBY GIVEN that the AA8-22 placer mining claim has been located by Arizona Assets, LLC whose current mailing address is 292 new river Cir., Henderson, Nevada 89052-2377

BLM	RECEIVED
DATE	BLM AT STATE OFFICE
STAMP	2020 SEP 11 A 8:21
	PHOENIX, ARIZONA

The general course of this claim is East to West and is situated in Pinal County, Arizona.

The claim is 1,320 feet in length and 660 feet in width. This claim runs from the location monument on which the location notice is posted (being the northeast corner of the said claim), approximately 660 feet in a southerly direction to the south end line and 1,320 feet in a westerly direction to the west end line.

The claim is marked by four 2"x2"x4' monuments, one at each corner of the claim.

The location monument on which this notice is posted is situated within Section 8, Township 9 South, Range 11 East, Gila Salt River Base and Meridian, Arizona. This claim encompasses portions of the following quarter section (s), section (s), Township (s) and Range (s)

S 1/2 of the NE 1/4 SW 1/4 of Section 8, Township 9, Range 11 South, Gila Salt River Base and Meridian, Arizona.

The locality of this claim with reference to some natural object or permanent monument and additional information (if any) concerning its locality are as follows: none

DATED AND POSTED on the ground this 4th day of September, 2020.

LOCATOR (s) Owner  
Arizona Assets, LLC

By Ron Parker

Ron Parker/Agent for Owners

ANC461004



# T9S R11E SECTION 8

## ARIZONA ASSETS AA CLAIM BLOCK

### AA8 CLAIM 01 THROUGH 32

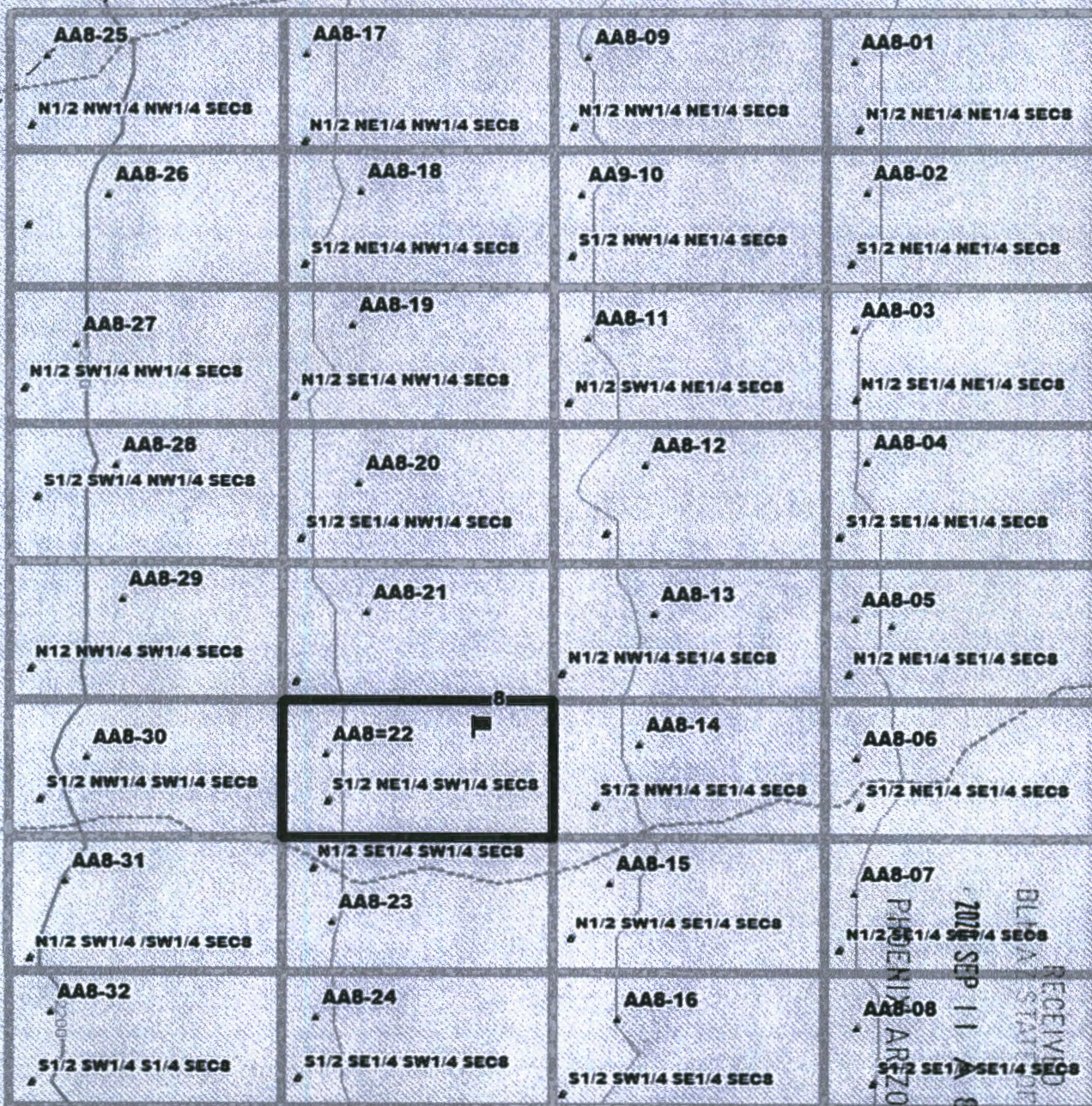

ANCHOR 1004

RECEIVED  
BLM STATION 101  
2018 SEP 11 A 8:21  
PHOENIX, ARIZONA

Data use subject to license.

© DeLorme. Topo North America™ 10.

www.delorme.com

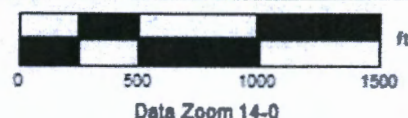



**LOCATION NOTICE FOR PLACER MINING CLAIM**

NOTICE IS HEREBY GIVEN that the AA8-23 placer mining claim has been located by Arizona Assets, LLC whose current mailing address is 292 new river Cir., Henderson, Nevada 89052-2377

BLM	RECEIVED
DATE	BLM AZ STATE OFFICE
STAMP	2020 SEP 11 A 8:21
	PHOENIX, ARIZONA

The general course of this claim is East to West and is situated in Pinal County, Arizona.

The claim is 1,320 feet in length and 660 feet in width. This claim runs from the location monument on which the location notice is posted (being the northeast corner of the said claim), approximately 660 feet in a southerly direction to the south end line and 1,320 feet in a westerly direction to the west end line.

The claim is marked by four 2"x2"x4' monuments, one at each corner of the claim.

The location monument on which this notice is posted is situated within Section 8, Township 9 South, Range 11 East, Gila Salt River Base and Meridian, Arizona. This claim encompasses portions of the following quarter section (s), section (s), Township (s) and Range (s)

N 1/2 of the SE 1/4 of the SW 1/4 of Section 8, Township 9, Range 11 South, Gila Salt River Base and Meridian, Arizona.

The locality of this claim with reference to some natural object or permanent monument and additional information (if any) concerning its locality are as follows: none

DATED AND POSTED on the ground this 4th day of September, 2020.

LOCATOR (s) Owner  
Arizona Assets, LLC

By Ron Parker

Ron Parker/Agent for Owners

AMC461005



# T9S R11E SECTION 8

## ARIZONA ASSETS AA CLAIM BLOCK

### AA8 CLAIM 01 THROUGH 32

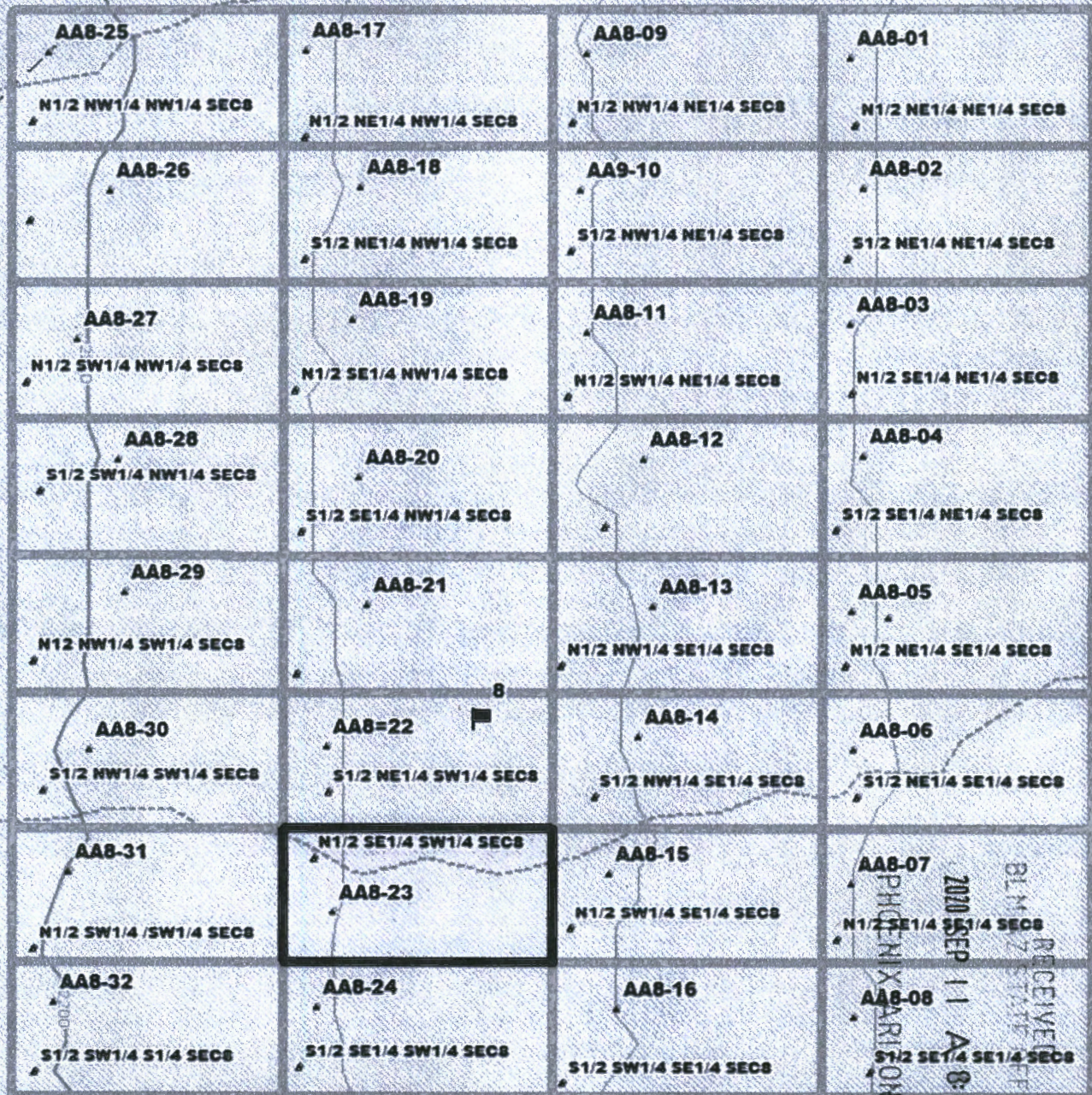

AMC461005

Data use subject to license.

© DeLorme. Topo North America™ 10.

www.delorme.com

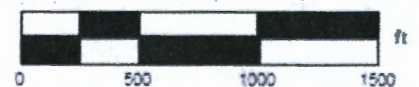

Data Zoom 14-0



**LOCATION NOTICE FOR PLACER MINING CLAIM**

NOTICE IS HEREBY GIVEN that the AA8-24 placer mining claim has been located by Arizona Assets, LLC whose current mailing address is 292 new river Cir., Henderson, Nevada 89052-2377

BLM	RECEIVED
DATE	BLM AZ STATE OFFICE
STAMP	2020 SEP 11 A 8:21
	PHOENIX, ARIZONA

The general course of this claim is East to West and is situated in Pinal County, Arizona.

The claim is 1,320 feet in length and 660 feet in width. This claim runs from the location monument on which the location notice is posted (being the northeast corner of the said claim), approximately 660 feet in a southerly direction to the south end line and 1,320 feet in a westerly direction to the west end line.

The claim is marked by four 2"x2"x4' monuments, one at each corner of the claim.

The location monument on which this notice is posted is situated within Section 8, Township 9 South, Range 11 East, Gila Salt River Base and Meridian, Arizona. This claim encompasses portions of the following quarter section (s), section (s), Township (s) and Range (s)

S 1/2 of the SE 1/4 of the SW 1/4 of Section 8, Township 9, Range 11 South, Gila Salt River Base and Meridian, Arizona.

The locality of this claim with reference to some natural object or permanent monument and additional information (if any) concerning its locality are as follows: none

DATED AND POSTED on the ground this 4th day of September, 2020.

LOCATOR (s) Owner  
Arizona Assets, LLC

By 

Ron Parker/Agent for Owners

AMC461006



# T9S R11E SECTION 8

## ARIZONA ASSETS AA CLAIM BLOCK

### AA8 CLAIM 01 THROUGH 32

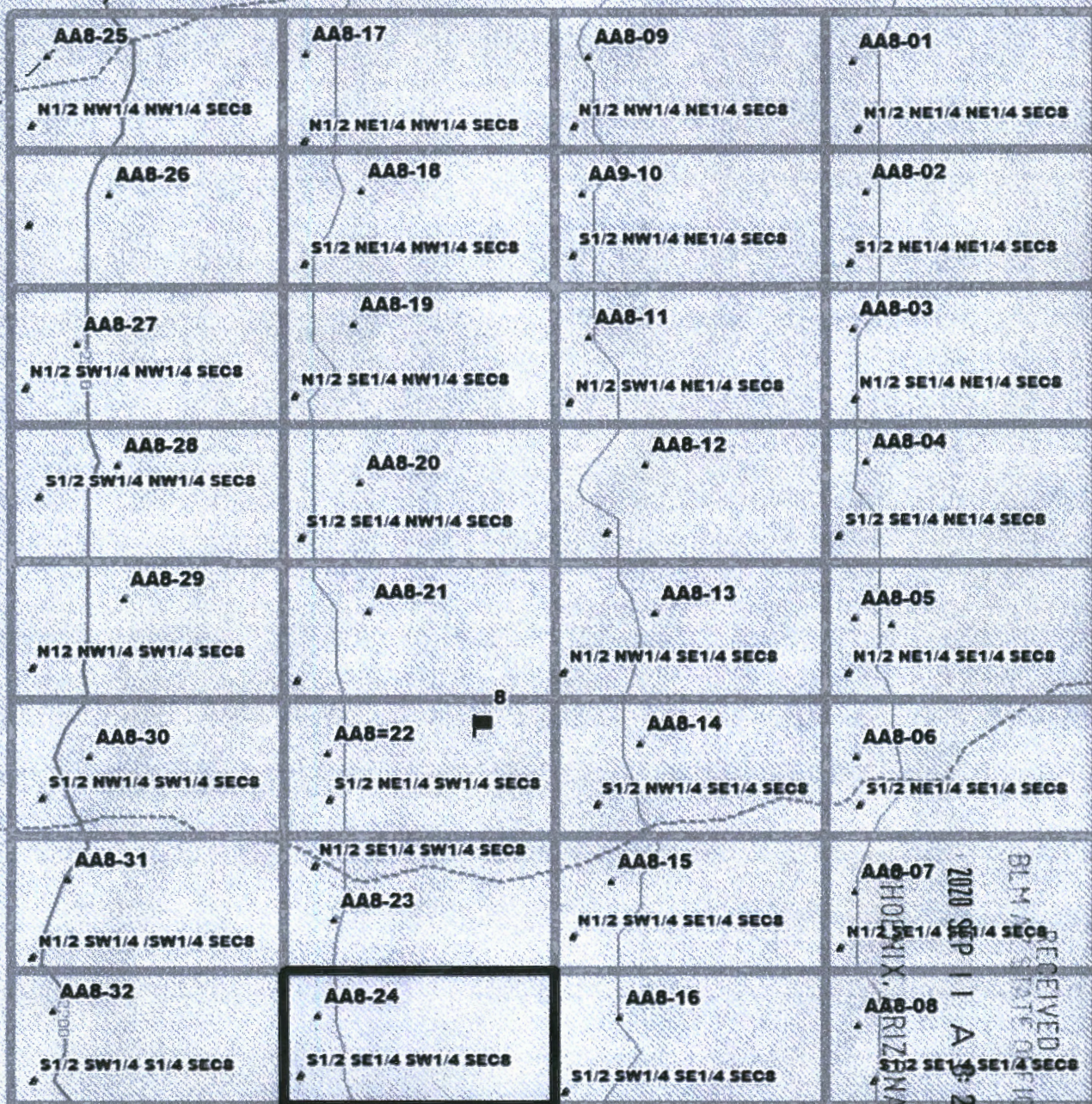

AMC461006

Data use subject to license

© DeLorme. Topo North America™ 10.

www.delorme.com

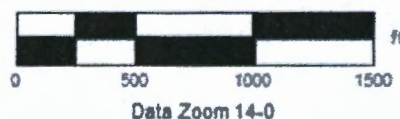

Data Zoom 14-0



**LOCATION NOTICE FOR PLACER MINING CLAIM**

NOTICE IS HEREBY GIVEN that the AA8-25 placer mining claim has been located by Arizona Assets, LLC whose current mailing address is 292 new river Cir., Henderson, Nevada 89052-2377

BLM	RECEIVED
DATE	BLM AZ STATE OFFICE
STAMP	2020 SEP 11 A 8:21
	PHOENIX, ARIZONA

The general course of this claim is East to West and is situated in Pinal County, Arizona.

The claim is 1,320 feet in length and 660 feet in width. This claim runs from the location monument on which the location notice is posted (being the northeast corner of the said claim), approximately 660 feet in a southerly direction to the south end line and 1,320 feet in a westerly direction to the west end line.

The claim is marked by four 2"x2"x4' monuments, one at each corner of the claim.

The location monument on which this notice is posted is situated within Section 8, Township 9 South, Range 11 East, Gila Salt River Base and Meridian, Arizona. This claim encompasses portions of the following quarter section (s), section (s), Township (s) and Range (s)

N 1/2 of the NW 1/4 of the NW 1/4 of Section 8, Township 9, Range 11 South, Gila Salt River Base and Meridian, Arizona.

The locality of this claim with reference to some natural object or permanent monument and additional information (if any) concerning its locality are as follows: none

DATED AND POSTED on the ground this 4th day of September, 2020.

LOCATOR (s) Owner  
Arizona Assets, LLC

By



Ron Parker/Agent for Owners

AMC461007



# T9S R11E SECTION 8

## ARIZONA ASSETS AA CLAIM BLOCK

### AA8 CLAIM 01 THROUGH 32

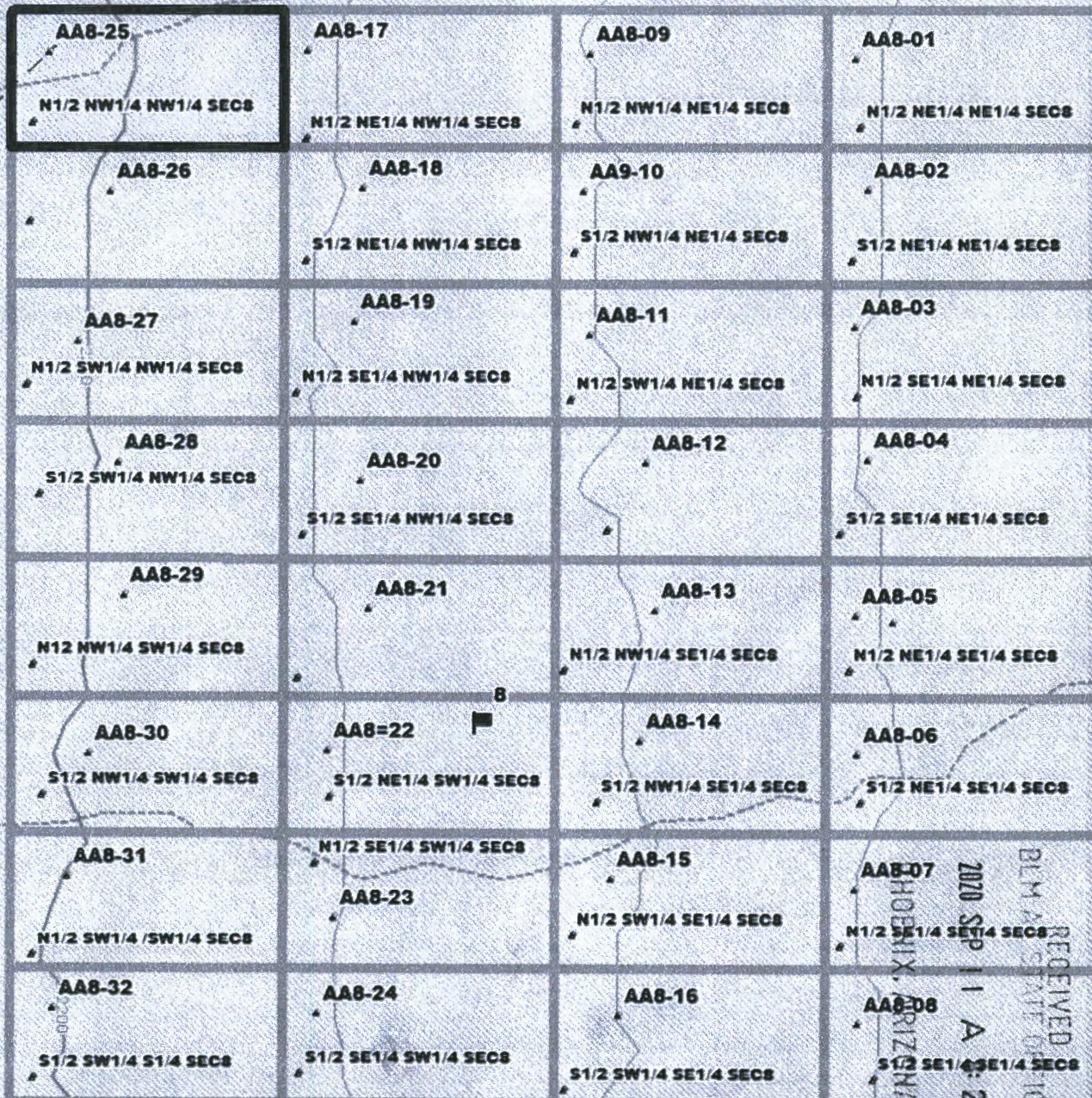

AMC461007

Data use subject to license.

© DeLorme. Topo North America™ 10.

www.delorme.com

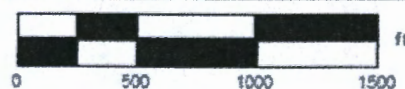

Data Zoom 14-0



**LOCATION NOTICE FOR PLACER MINING CLAIM**

NOTICE IS HEREBY GIVEN that the AA8-26 placer mining claim has been located by Arizona Assets, LLC whose current mailing address is 292 new river Cir., Henderson, Nevada 89052-2377

BLM	RECEIVED
DATE	2020 SEP 11 A 8:21
STAMP	PHOENIX, ARIZONA

The general course of this claim is East to West and is situated in Pinal County, Arizona.

The claim is 1,320 feet in length and 660 feet in width. This claim runs from the location monument on which the location notice is posted (being the northeast corner of the said claim), approximately 660 feet in a southerly direction to the south end line and 1,320 feet in a westerly direction to the west end line.

The claim is marked by four 2"x2"x4' monuments, one at each corner of the claim.

The location monument on which this notice is posted is situated within Section 8, Township 9 South, Range 11 East, Gila Salt River Base and Meridian, Arizona. This claim encompasses portions of the following quarter section (s), section (s), Township (s) and Range (s)

S 1/2 of the NW 1/4 of the NW 1/4 of Section 8, Township 9, Range 11 South, Gila Salt River Base and Meridian, Arizona.

The locality of this claim with reference to some natural object or permanent monument and additional information (if any) concerning its locality are as follows: none

DATED AND POSTED on the ground this 4th day of September, 2020.

LOCATOR (s) Owner  
Arizona Assets, LLC

By Ron Parker

Ron Parker/Agent for Owners

AMC461008

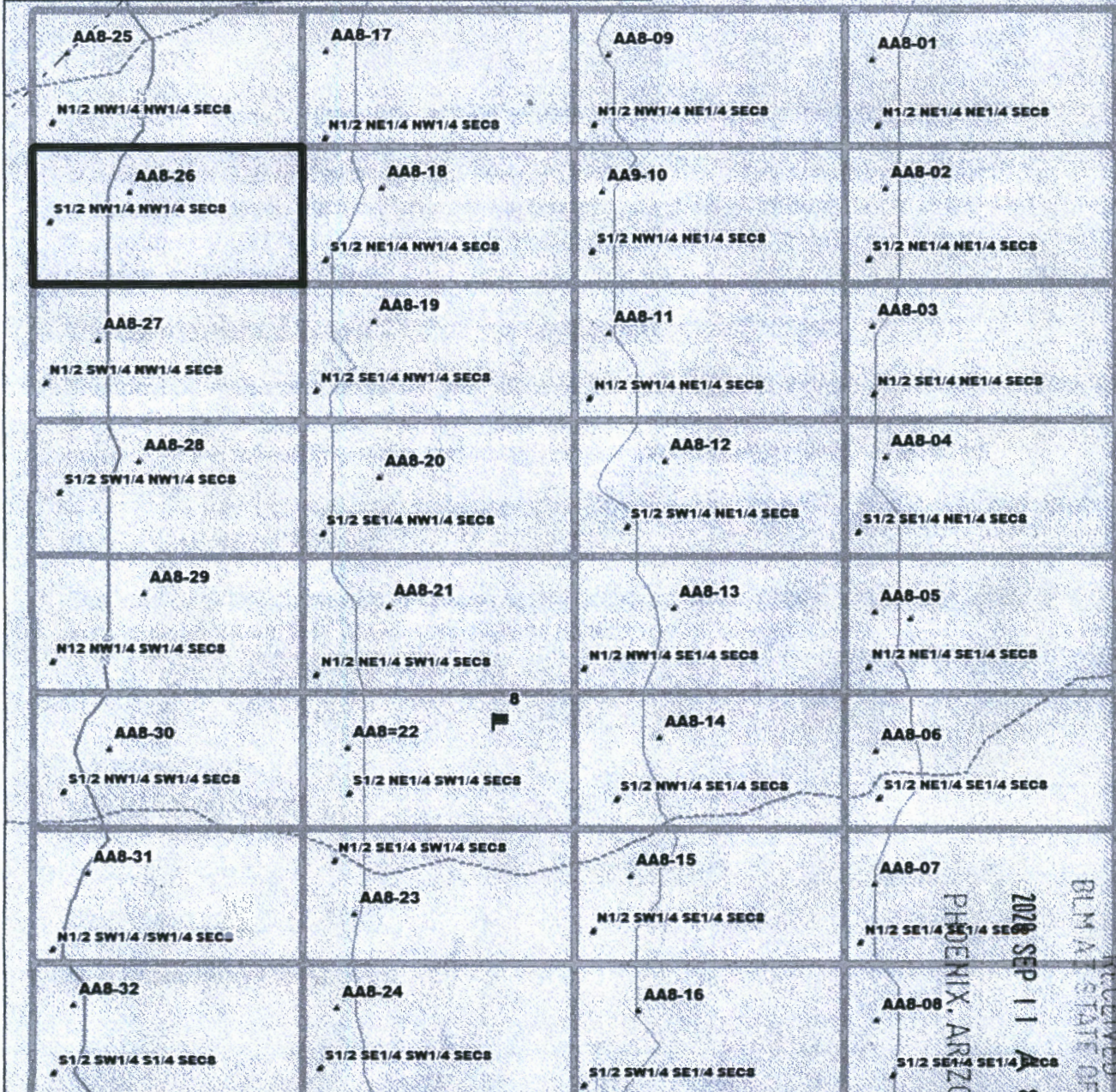

**T9S R11E SECTION 8****ARIZONA ASSETS AA CLAIM BLOCK****AA8 CLAIM 01 THROUGH 32**

AMC461008

RECEIVED  
BLM STATE OFFICE  
2020 SEP 11 8:21  
PHOENIX, ARIZONA

Data use subject to license

© DeLorme. Topo North America™ 10.

www.delorme.com



MN (9.7° E)

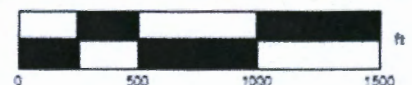

Data Zoom 14-3



**LOCATION NOTICE FOR PLACER MINING CLAIM**

NOTICE IS HEREBY GIVEN that the AA8-27 placer mining claim has been located by Arizona Assets, LLC whose current mailing address is 292 new river Cir., Henderson, Nevada 89052-2377

BLM	RECEIVED
DATE	BLM AZ STATE OFFICE
STAMP	2020 SEP 11 A 8:21
	PHOENIX, ARIZONA

The general course of this claim is East to West and is situated in Pinal County, Arizona.

The claim is 1,320 feet in length and 660 feet in width. This claim runs from the location monument on which the location notice is posted (being the northeast corner of the said claim), approximately 660 feet in a southerly direction to the south end line and 1,320 feet in a westerly direction to the west end line.

The claim is marked by four 2"x2"x4' monuments, one at each corner of the claim.

The location monument on which this notice is posted is situated within Section 8, Township 9 South, Range 11 East, Gila Salt River Base and Meridian, Arizona. This claim encompasses portions of the following quarter section (s), section (s), Township (s) and Range (s)

N 1/2 of the SW 1/4 of the NW 1/4 of Section 8, Township 9, Range 11 South, Gila Salt River Base and Meridian, Arizona.

The locality of this claim with reference to some natural object or permanent monument and additional information (if any) concerning its locality are as follows: none

DATED AND POSTED on the ground this 4th day of September, 2020.

LOCATOR (s) Owner  
Arizona Assets, LLC

By Ron Parker

Ron Parker/Agent for Owners

AMC461009



# T9S R11E SECTION 8

## ARIZONA ASSETS AA CLAIM BLOCK

### AA8 CLAIM 01 THROUGH 32

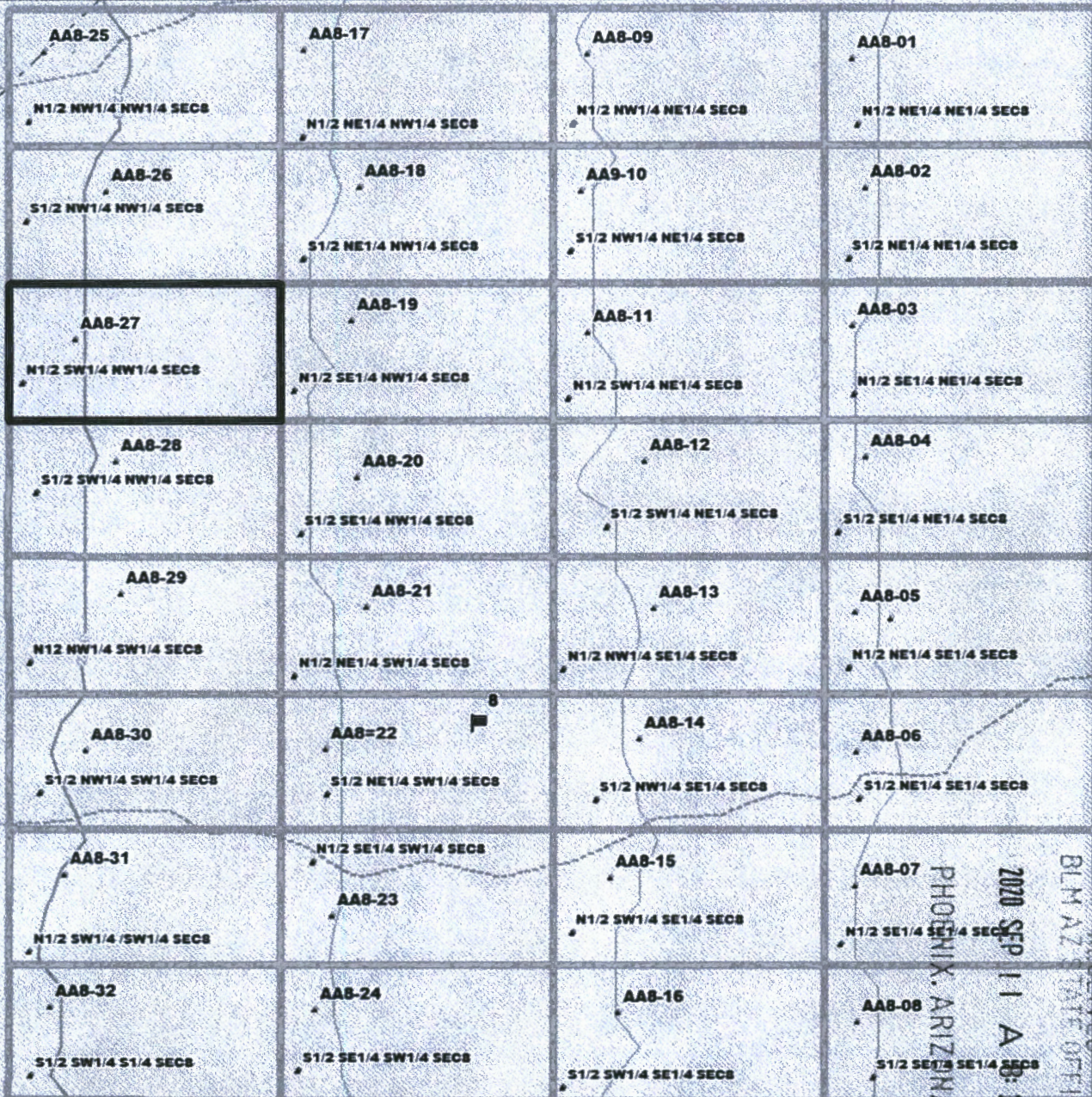

AMC461009

RECEIVED  
BLM AZ STATE OFFICE  
2020 SEP 11 AM 8:22  
PHOENIX, ARIZONA

Data use subject to license

© DeLorme. Topo North America™ 10.

www.delorme.com

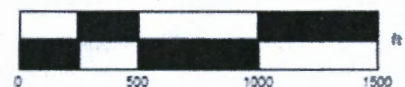

Data Zoom 14-3



**LOCATION NOTICE FOR PLACER MINING CLAIM**

NOTICE IS HEREBY GIVEN that the AA8-28 placer mining claim has been located by Arizona Assets, LLC whose current mailing address is 292 new river Cir., Henderson, Nevada 89052-2377

BLM	RECEIVED
DATE	BLM AZ STATE OFFICE
STAMP	2020 SEP 11 A 8:22
	PHOENIX, ARIZONA

The general course of this claim is East to West and is situated in Pinal County, Arizona.

The claim is 1,320 feet in length and 660 feet in width. This claim runs from the location monument on which the location notice is posted (being the northeast corner of the said claim), approximately 660 feet in a southerly direction to the south end line and 1,320 feet in a westerly direction to the west end line.

The claim is marked by four 2"x2"x4' monuments, one at each corner of the claim.

The location monument on which this notice is posted is situated within Section 8, Township 9 South, Range 11 East, Gila Salt River Base and Meridian, Arizona. This claim encompasses portions of the following quarter section (s), section (s), Township (s) and Range (s)

S 1/2 of the SW 1/4 of the NW 1/4 of Section 8, Township 9, Range 11 South, Gila Salt River Base and Meridian, Arizona.

The locality of this claim with reference to some natural object or permanent monument and additional information (if any) concerning its locality are as follows: none

DATED AND POSTED on the ground this 4th day of September, 2020.

LOCATOR (s) Owner  
Arizona Assets, LLC

By Ron Parker

Ron Parker/Agent for Owners

AMC461010



# T9S R11E SECTION 8

## ARIZONA ASSETS AA CLAIM BLOCK

### AA8 CLAIM 01 THROUGH 32



AMC461010

RECEIVED  
BLM ARIZONA OFFICE  
2020 SEP 11 10:22  
PHOENIX, ARIZONA

Data use subject to license

© DeLorme. Topo North America™ 10.

www.delorme.com



Data Zoom 14-3



**LOCATION NOTICE FOR PLACER MINING CLAIM**

NOTICE IS HEREBY GIVEN that the AA8-29 placer mining claim has been located by Arizona Assets, LLC whose current mailing address is 292 new river Cir., Henderson, Nevada 89052-2377

BLM	RECEIVED
DATE	BLM AZ STATE OFFICE
STAMP	2020 SEP 11 A 8:22
	PHOENIX, ARIZONA

The general course of this claim is East to West and is situated in Pinal County, Arizona.

The claim is 1,320 feet in length and 660 feet in width. This claim runs from the location monument on which the location notice is posted (being the northeast corner of the said claim), approximately 660 feet in a southerly direction to the south end line and 1,320 feet in a westerly direction to the west end line.

The claim is marked by four 2"x2"x4' monuments, one at each corner of the claim.

The location monument on which this notice is posted is situated within Section 8, Township 9 South, Range 11 East, Gila Salt River Base and Meridian, Arizona. This claim encompasses portions of the following quarter section (s), section (s), Township (s) and Range (s)

N 1/2 of the NW 1/4 of the SW 1/4 of Section 8, Township 9, Range 11 South, Gila Salt River Base and Meridian, Arizona.

The locality of this claim with reference to some natural object or permanent monument and additional information (if any) concerning its locality are as follows: none

DATED AND POSTED on the ground this 4th day of September, 2020.

LOCATOR (s) Owner  
Arizona Assets, LLC

By Ron Parker

Ron Parker/Agent for Owners

AMC461011



# T9S R11E SECTION 8

## ARIZONA ASSETS AA CLAIM BLOCK

### AA8 CLAIM 01 THROUGH 32



AMC461011

RECEIVED  
BLM AL STATE OFFICE  
2022 SEP 11 10:22  
PHOENIX ARIZONA

Data use subject to license

© DeLorme. Topo North America™ 10.

www.delorme.com



MN (9.7° E)

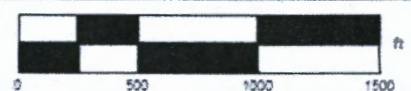

Data Zoom 14-3



**LOCATION NOTICE FOR PLACER MINING CLAIM**

NOTICE IS HEREBY GIVEN that the AA8-30 placer mining claim has been located by Arizona Assets, LLC whose current mailing address is 292 new river Cir., Henderson, Nevada 89052-2377

BLM	2020 SEP 11 A 8:22	RECEIVED
DATE	PHOENIX, ARIZONA	BLM AZ STATE OFFICE
STAMP		

The general course of this claim is East to West and is situated in Pinal County, Arizona.

The claim is 1,320 feet in length and 660 feet in width. This claim runs from the location monument on which the location notice is posted (being the northeast corner of the said claim), approximately 660 feet in a southerly direction to the south end line and 1,320 feet in a westerly direction to the west end line.

The claim is marked by four 2"x2"x4' monuments, one at each corner of the claim.

The location monument on which this notice is posted is situated within Section 8, Township 9 South, Range 11 East, Gila Salt River Base and Meridian, Arizona. This claim encompasses portions of the following quarter section (s), section (s), Township (s) and Range (s)

S 1/2 of the NW 1/4 of the SW 1/4 of Section 8, Township 9, Range 11 South, Gila Salt River Base and Meridian, Arizona.

The locality of this claim with reference to some natural object or permanent monument and additional information (if any) concerning its locality are as follows: none

DATED AND POSTED on the ground this 4th day of September, 2020.

LOCATOR (s) Owner  
Arizona Assets, LLC

By Ron Parker

Ron Parker/Agent for Owners

AMC461012



# T9S R11E SECTION 8

## ARIZONA ASSETS AA CLAIM BLOCK

### AA8 CLAIM 01 THROUGH 32



AMC461012

RECEIVED  
BLM AL STATE OFFICE  
2020 SEP 11 AM 8:22  
PHOENIX, ARIZONA

Data use subject to license

© DeLorme. Topo North America™ 10.

www.delorme.com

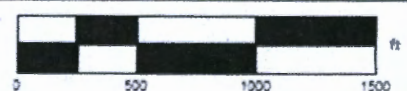

Data Zoom 14-3



**LOCATION NOTICE FOR PLACER MINING CLAIM**

NOTICE IS HEREBY GIVEN that the AA8-31 placer mining claim has been located by Arizona Assets, LLC whose current mailing address is 292 new river Cir., Henderson, Nevada 89052-2377

BLM	RECEIVED
DATE	BLM AZ STATE OFFICE
STAMP	2020 SEP 11 A 8:22
	PHOENIX, ARIZONA

The general course of this claim is East to West and is situated in Pinal County, Arizona.

The claim is 1,320 feet in length and 660 feet in width. This claim runs from the location monument on which the location notice is posted (being the northeast corner of the said claim), approximately 660 feet in a southerly direction to the south end line and 1,320 feet in a westerly direction to the west end line.

The claim is marked by four 2"x2"x4' monuments, one at each corner of the claim.

The location monument on which this notice is posted is situated within Section 8, Township 9 South, Range 11 East, Gila Salt River Base and Meridian, Arizona. This claim encompasses portions of the following quarter section (s), section (s), Township (s) and Range (s)

N 1/2 of the SW1/4 of the SW 1/4 of Section 8, Township 9, Range 11 South, Gila Salt River Base and Meridian, Arizona.

The locality of this claim with reference to some natural object or permanent monument and additional information (if any) concerning its locality are as follows: none

DATED AND POSTED on the ground this 4th day of September, 2020.

LOCATOR (s) Owner  
Arizona Assets, LLC

By



Ron Parker/Agent for Owners

ANC461013



# T9S R11E SECTION 8

## ARIZONA ASSETS AA CLAIM BLOCK

### AA8 CLAIM 01 THROUGH 32

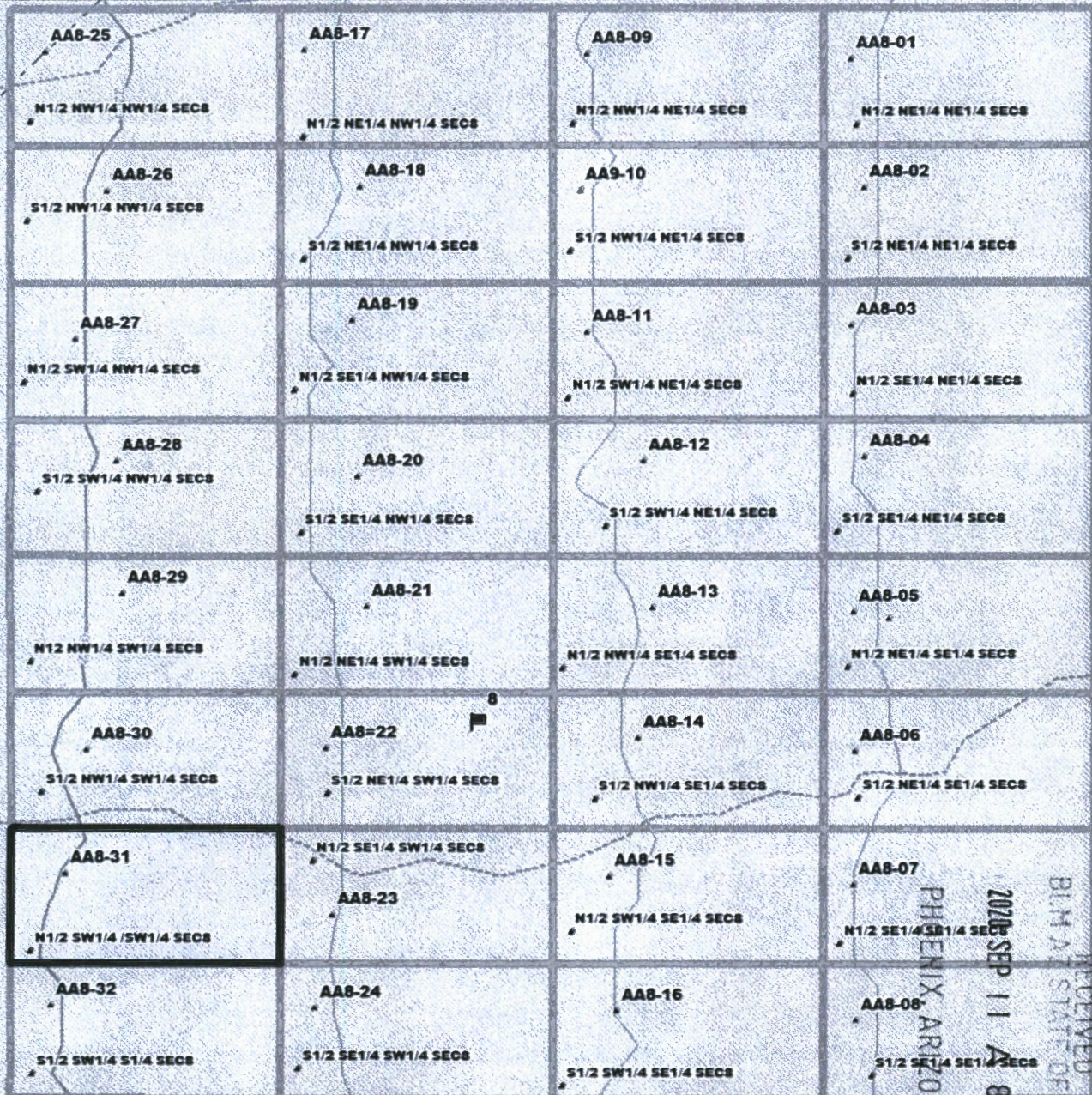

AMC461013

RECEIVED  
BLM AT STATE OF ICF  
2025 SEP 11 A 8:22  
PHOENIX, ARIZONA

Data use subject to license

© DeLorme. Topo North America™ 10.

www.delorme.com



MN (9.7° E)

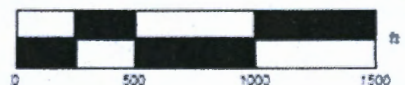

Data Zoom 14-3



**LOCATION NOTICE FOR PLACER MINING CLAIM**

NOTICE IS HEREBY GIVEN that the AA8-32 placer mining claim has been located by Arizona Assets, LLC whose current mailing address is 292 new river Cir., Henderson, Nevada 89052-2377

BLM	RECEIVED
DATE	BLM AZ STATE OFFICE
STAMP	2020 SEP 11 A 8:22
	PHOENIX, ARIZONA

The general course of this claim is East to West and is situated in Pinal County, Arizona.

The claim is 1,320 feet in length and 660 feet in width. This claim runs from the location monument on which the location notice is posted (being the northeast corner of the said claim), approximately 660 feet in a southerly direction to the south end line and 1,320 feet in a westerly direction to the west end line.

The claim is marked by four 2"x2"x4' monuments, one at each corner of the claim.

The location monument on which this notice is posted is situated within Section 8, Township 9 South, Range 11 East, Gila Salt River Base and Meridian, Arizona. This claim encompasses portions of the following quarter section (s), section (s), Township (s) and Range (s)

S 1/2 of the SW1/4 of the SW 1/4 of Section 8, Township 9, Range 11 South, Gila Salt River Base and Meridian, Arizona. The locality of this claim with reference to some natural object or permanent monument and additional information (if any) concerning its locality are as follows: none

DATED AND POSTED on the ground this 4th day of September, 2020.

LOCATOR (s) Owner  
Arizona Assets, LLC

By Ron Parker

Ron Parker/Agent for Owners

AMC461014



# T9S R11E SECTION 8

## ARIZONA ASSETS AA CLAIM BLOCK

### AA8 CLAIM 01 THROUGH 32

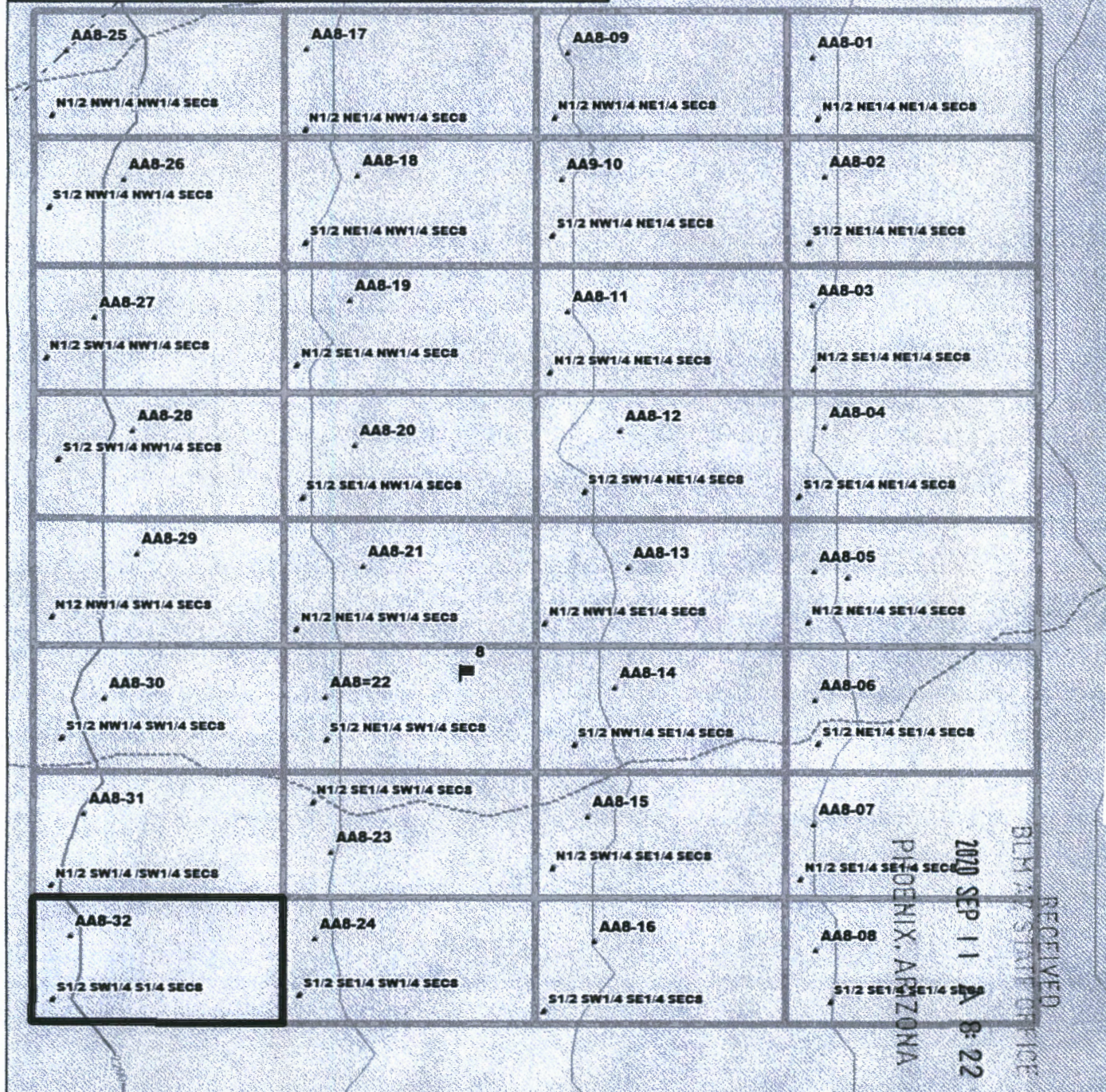

AMC461014

RECEIVED  
BLM STAFF OFFICE  
2020 SEP 11 8:22  
PHOENIX, ARIZONA

Data use subject to license

© DeLorme. Topo North America™ 10.

www.delorme.com



MN (9.7° E)

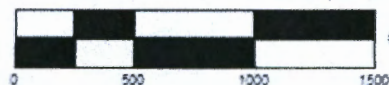

Data Zoom 14-3



Date and Time Run:  
9/16/2020 10:35:45 AM

Page 1 of 1

DEPARTMENT OF THE INTERIOR  
BUREAU OF LAND MANAGEMENT  
Case Recordation

**Geographic Report with Land**

Disposition is equal to **AUTHORIZED , CANCELLED , EXPIRED , PENDING , REJECTED , RELINQUISHED ,  
WITHDRAWN**

and Meridian Township Range Section is equal to **14 0090S 0110E 008**

and Admin State is equal to **AZ**

NO WARRANTY IS MADE BY BLM  
FOR USE OF THE DATA FOR  
PURPOSES NOT INTENDED BY BLM



DEPARTMENT OF THE INTERIOR  
BUREAU OF LAND MANAGEMENT  
Case Recordation  
Geographic Report with Land

Admin State: AZ  
Geo State: AZ  
Serial Number: AZA 003670

Total Case Acres: 12.560

Casetype	Case Disp	Mer	Twp	Rng	Sec	Sur Type	Sur Nr	Suf	Subdivision	Pending Action
285002	AUTHORIZED	14	0090S	0110E	008	ALIQ			N2NW;	

Admin State: AZ  
Geo State: AZ  
Serial Number: AZA 037720

Total Case Acres: 12.550

Casetype	Case Disp	Mer	Twp	Rng	Sec	Sur Type	Sur Nr	Suf	Subdivision	Pending Action
285003	AUTHORIZED	14	0090S	0110E	008	ALIQ			NWNW;	

Admin State: AZ  
Geo State: AZ  
Serial Number: AZPHX 0078163

Total Case Acres: 155.950

Casetype	Case Disp	Mer	Twp	Rng	Sec	Sur Type	Sur Nr	Suf	Subdivision	Pending Action
288100	AUTHORIZED	14	0090S	0110E	008	ALIQ			NWNW;	



10

PINAL COUNTY  
TUCSON FIELD OFFICE

## STATUS OF PUBLIC DOMAIN LAND AND MINERAL TITLES

[illegible]

FOR ORDERS AFFECTING DISPOSAL OR USE OF  
UNIDENTIFIED LANDS WITHDRAWN FOR CLASSIFICATION,  
MINERALS, WATER AND/OR OTHER PUBLIC PURPOSES,  
REFER TO INDEX OF MISCELLANEOUS DOCUMENTS.

Blank lined paper for writing.

Lat 32°35'48"N  
Long 111°09'08"W

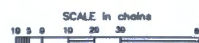

**WARNING STATEMENT**  
This plot is in the Bureau's Record of Title, and should be used only as a graphic display of the township survey data. Records hereon do not reflect title changes which may have been affected by lateral movements of rivers or other bodies of water. Refer to the cadastral surveys for official survey information.

CURRENT TO	LT	GSR Mer
8-31-2017	ACAD	T 9 S
		R 11 E



R&D Adventures LLC  
14700 N Shotgun Pl  
Oro Valley, AZ 85755

TIVEN

BLM

2020 SEP 11 A 8:22

PHOENIX ARIZONA

Bureau of Land Management  
One North Central Ave.  
Suite 800  
Phoenix, AZ 85004-4427



RECEIVED  
9LM AZS

2020 SEP 11 A 8:22

PHOENIX, ARIZONA

Payment for  
AA8 claims



PRESS FIRMLY TO SEAL

PRESS FIRMLY TO SEAL



**PRIORITY<sup>®</sup>  
MAIL<sup>®</sup>  
EXPRESS<sup>®</sup>**

RECEIVED  
BIRMINGHAM OFFICE  
2020 SEP 11 A 8:22  
PHOENIX, ARIZONA

To schedule free  
Package Pickup,  
scan the QR code.



USPS.COM/PICKUP



PS 10001000006



**PRIORITY<sup>®</sup>  
MAIL<sup>®</sup>  
EXPRESS<sup>®</sup>**

CUSTOMER USE ONLY

FROM: (PLEASE PRINT)

PHONE (520) 471-2705

R4D Adventures  
1700 N Shotgun Pl  
Oro Valley, AZ 85755

DELIVERY OPTIONS (Customer Use Only)

**SIGNATURE REQUIRED** Note: The mailer must check the "Signature Required" box if the mailer: 1) Requires the addressee's signature; OR 2) Purchases additional insurance; OR 3) Purchases COD service; OR 4) Purchases Return Receipt service. If the box is not checked, the Postal Service will leave the item in the addressee's mail receptacle or other secure location without attempting to obtain the addressee's signature on delivery.

Delivery Options

- ☐ No Saturday Delivery (delivered next business day)
- ☐ Sunday/Holiday Delivery Required (additional fee, where available)
- ☐ 10:30 AM Delivery Required (additional fee, where available)
- \*Refer to USPS.com or local Post Office for availability.

TO: (PLEASE PRINT)

PHONE ( )

Bureau of Land Management  
One North Central Ave.  
Phoenix AZ, 85004-4427

ZIP + 4 (U.S. ADDRESSES ONLY)

85004-4427

- For pickup or USPS Tracking<sup>™</sup>, visit USPS.com or call 800-222-1811.
- \$100.00 insurance included.

**PEEL FROM THIS CORNER**

EP1  
OD: 12 1/2 x 9 1/2



1007



85004

U.S. POSTAGE PAID  
PME 1-Day  
TUCSON, AZ  
85737  
SEP 09, 20  
AMOUNT

**\$26.35**

R2305E125637-15



EJ 314 439 492 US

PAYMENT BY ACCOUNT (if applicable)

USPS<sup>®</sup> Corporate Acct. No.

Federal Agency Acct. No. or Postal Service<sup>™</sup> Acct. No.

ORIGIN (POSTAL SERVICE USE ONLY)

<input checked="" type="checkbox"/> 1-Day	<input type="checkbox"/> 2-Day	<input type="checkbox"/> Military	<input type="checkbox"/> DPO
PO ZIP Code 85737	Scheduled Delivery Date (MM/DD/YYYY) 9-10-2020	Postage \$ 26.35	
Date Accepted (MM/DD/YYYY) 9-9-2020	Scheduled Delivery Time <input type="checkbox"/> 10:30 AM <input checked="" type="checkbox"/> 12:00 PM	Insurance Fee \$	COD Fee \$
Time Accepted 4:12 PM	10:30 AM Delivery Fee \$	Return Receipt Fee \$	Live Animal Transportation Fee \$
Special Handling/Fragile \$	Sunday/Holiday Premium Fee \$	Total Postage & Fees \$ 26.35	
Weight 13.0	Acceptance Employee Initials HB		
DELIVERY (POSTAL SERVICE USE ONLY)			
Delivery Attempt (MM/DD/YYYY)	Time <input type="checkbox"/> AM <input type="checkbox"/> PM	Employee Signature	
Delivery Attempt (MM/DD/YYYY)	Time <input type="checkbox"/> AM <input type="checkbox"/> PM	Employee Signature	

LABEL 11-B, MARCH 2019

PSN 7690-02-000-9096



This packaging is the property of the U.S. Postal Service<sup>®</sup> and is provided solely for use in sending Priority Mail Express<sup>™</sup> shipments. Misuse may be a violation of federal law. This packaging is not for resale. EPI3F © U.S. Postal Service; October 2018; All rights reserved.

\* Money Back Guarantee to U.S., select APO/FPO/DPO, and select International destinations. See DMM and IMM at ps.usps.com for complete details.

† Money Back Guarantee for U.S. destinations only.

\* For Domestic shipments, the maximum weight is 70 lbs. For International shipments, the maximum weight is 4 lbs.





**GUARANTEED\***



**TRACKED**



**INSURED**



**PRIORITY<sup>®</sup>  
MAIL  
EXPRESS**

**FLAT RATE ENVELOPE**  
ONE RATE ★ ANY WEIGHT\*



PS 10001000006

EP13F Oct 2018  
OD: 12 1/2 x 9 1/2

**VISIT US AT USPS.COM<sup>®</sup>**  
ORDER FREE SUPPLIES ONLINE

\* Money back guarantee to U.S., select APO/FPO/DPO, and select International destinations. See DMM and IMM at [pe.usps.com](http://pe.usps.com) for complete details.  
\*\* For Domestic shipments, the maximum weight is 70 lbs. For International shipments, the maximum weight is 4 lbs.